

SCOTT PLAZA

16256 MILITARY ROAD SOUTH, SEATAC, WA 98188



OFFERING SUMMARY

Available SF:	1,626 SF
Lease Rate:	\$18.00 SF/yr (NNN)
Lot Size:	1.89 Acres
Year Built:	2005
Building Size:	23,115 SF
Renovated:	2005
Zoning:	NB
Market:	SeaTac

PROPERTY OVERVIEW

Class A retail center across from Safeway and minutes from SeaTac Airport and International Blvd. Excellent visibility with secure underground parking. Come Join H&R Block, Hair Masters, Cricket Wireless, Laborworks and other great tenants in this upscale retail center.

PROPERTY HIGHLIGHTS

- Newer Retail Center
- Last Available Space
- Excellent Visibility and Signage
- Easy Access and Parking
- Great Tenant Mix



DAVID HALL, CCIM
206.381.3883 x107
david@corecommercialproperties.com

AVAILABLE SPACES

SCOTT PLAZA

16256 MILITARY ROAD SOUTH, SEATAC, WA 98188

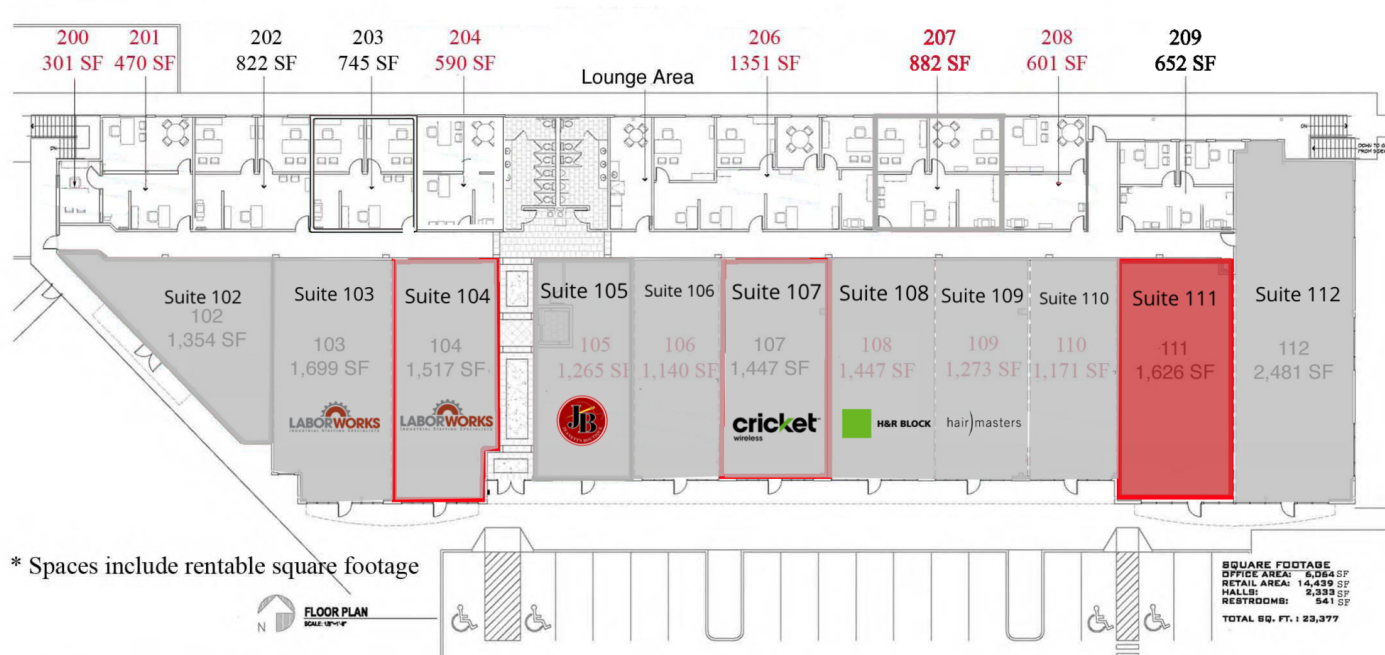

SCOTT PLAZA

All information is provided without warranties or guaranties. Tenant should independently verify all measurements and information provided herein.

UNAVAILABLE

AVAILABLE

SUITE	TENANT	SIZE	TYPE	RATE	DESCRIPTION
Suite 111	Available	1,626 SF	NNN	\$18.00 SF/yr	Open floorplan, great signage.



DAVID HALL, CCIM

206.381.3883 x107

david@corecommercialproperties.com

CORE Commercial Properties, Inc. | 10 East Allison Street | Seattle, WA 98102 | 206.707.9000 | corecommercialproperties.com

ADDITIONAL PHOTOS

SCOTT PLAZA

16256 MILITARY ROAD SOUTH, SEATAC, WA 98188



DAVID HALL, CCIM

206.381.3883 x107

david@corecommercialproperties.com

CORE Commercial Properties, Inc. | 10 East Allison Street | Seattle, WA 98102 | 206.707.9000 | corecommercialproperties.com

The information herein comes from sources deemed reliable but has not been independently verified by CORE Commercial Properties, Inc. No warranty or representation, expressed or implied is made as to the accuracy of the information herein, and it is submitted subject to errors, omissions, change of price, rental, or other conditions, withdrawal without notice, and to any special listing conditions, imposed by our principals.

SCOTT PLAZA

16256 MILITARY ROAD SOUTH, SEATAC, WA 98188



DAVID HALL, CCIM
206.381.3883 x107
david@corecommercialproperties.com

LOCATION MAP

SCOTT PLAZA

16256 MILITARY ROAD SOUTH, SEATAC, WA 98188

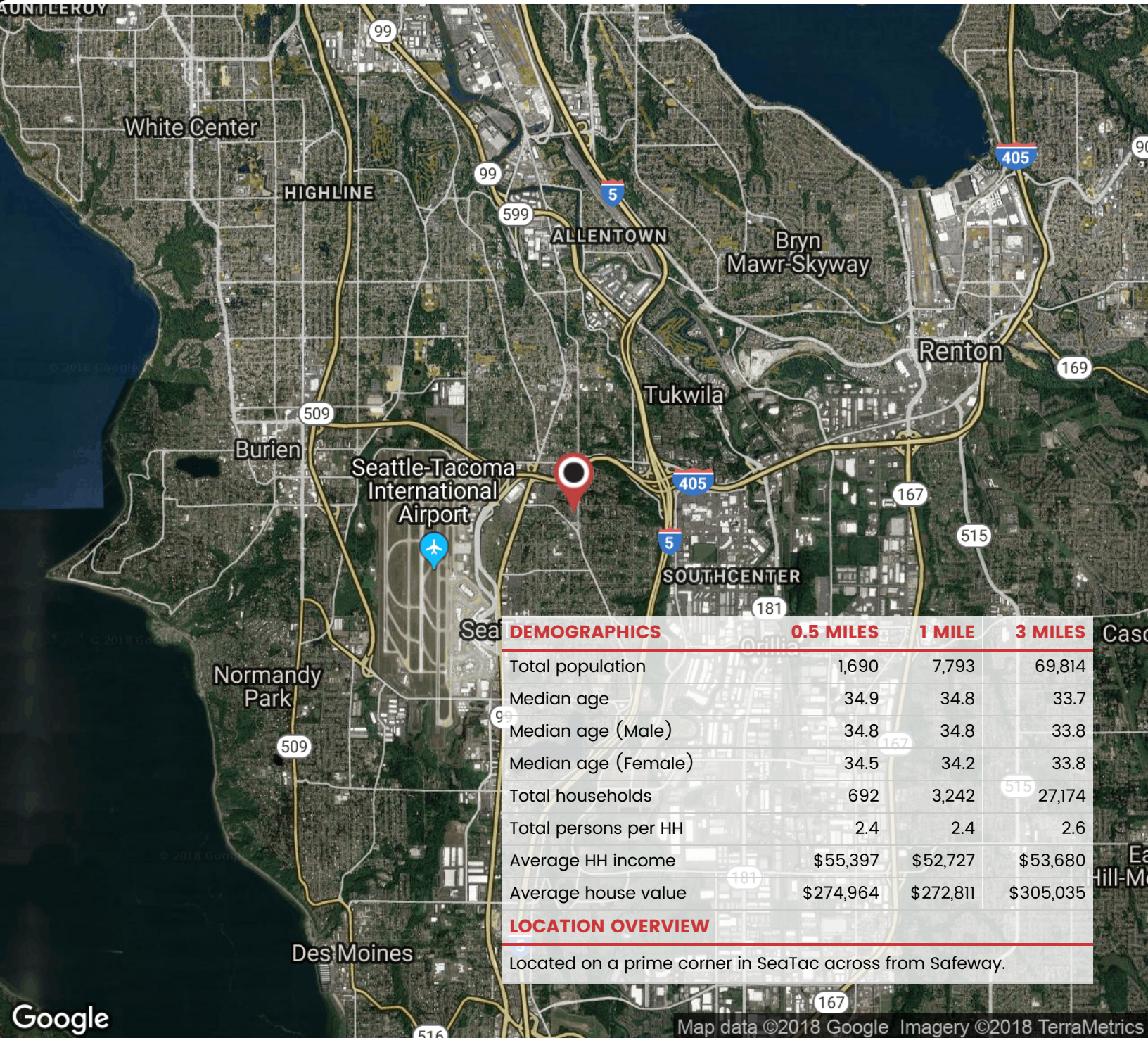

DAVID HALL, CCIM
206.381.3883 x107
david@corecommercialproperties.com

CORE Commercial Properties, Inc. | 10 East Allison Street | Seattle, WA 98102 | 206.707.9000 | corecommercialproperties.com

The information herein comes from sources deemed reliable but has not been independently verified by CORE Commercial Properties, Inc. No warranty or representation, expressed or implied is made as to the accuracy of the information herein, and it is submitted subject to errors, omissions, change of price, rental, or other conditions, withdrawal without notice, and to any special listing conditions, imposed by our principals.