



LANDMARK  
COMMERCIAL  
REAL ESTATE



# REGENCY LAKES PRIME JUNIOR BOX RETAIL FOR LEASE

2423 N Greenwich, Wichita, KS 67226

# PROPERTY SUMMARY

## PLEASE CALL FOR PRICING

**Location** 2423 N Greenwich, Wichita, KS 67226

**Available Space** 18,500 SF

**Lot Size** 3.65 acres (158,816 SF)

**Parking** Over 400 spots

**Year Built** 2005

**Center Tenants** Super Target, Hobby Lobby, Cabela's, Chili's, Hampton Inn, Subway, Slim Chickens, Subway, Mcdonald's and more!

**Area Neighbors** Dave and Buster's, REI, Academy Sports, Chick-fil-A, Stryker Sports Complex, Topgolf, Wichita Sports Forum, and many more!

# PROPERTY HIGHLIGHTS

- This is an excellent site for a retailer to establish a strong presence in east Wichita. Near highway access and along a main city thoroughfare, the Regency Lakes shopping center is home to some of Wichita's most popular shopping and dining destinations.
- Easy access and visibility from K-96 (36,900 VPD).



# INTERIOR PHOTOS



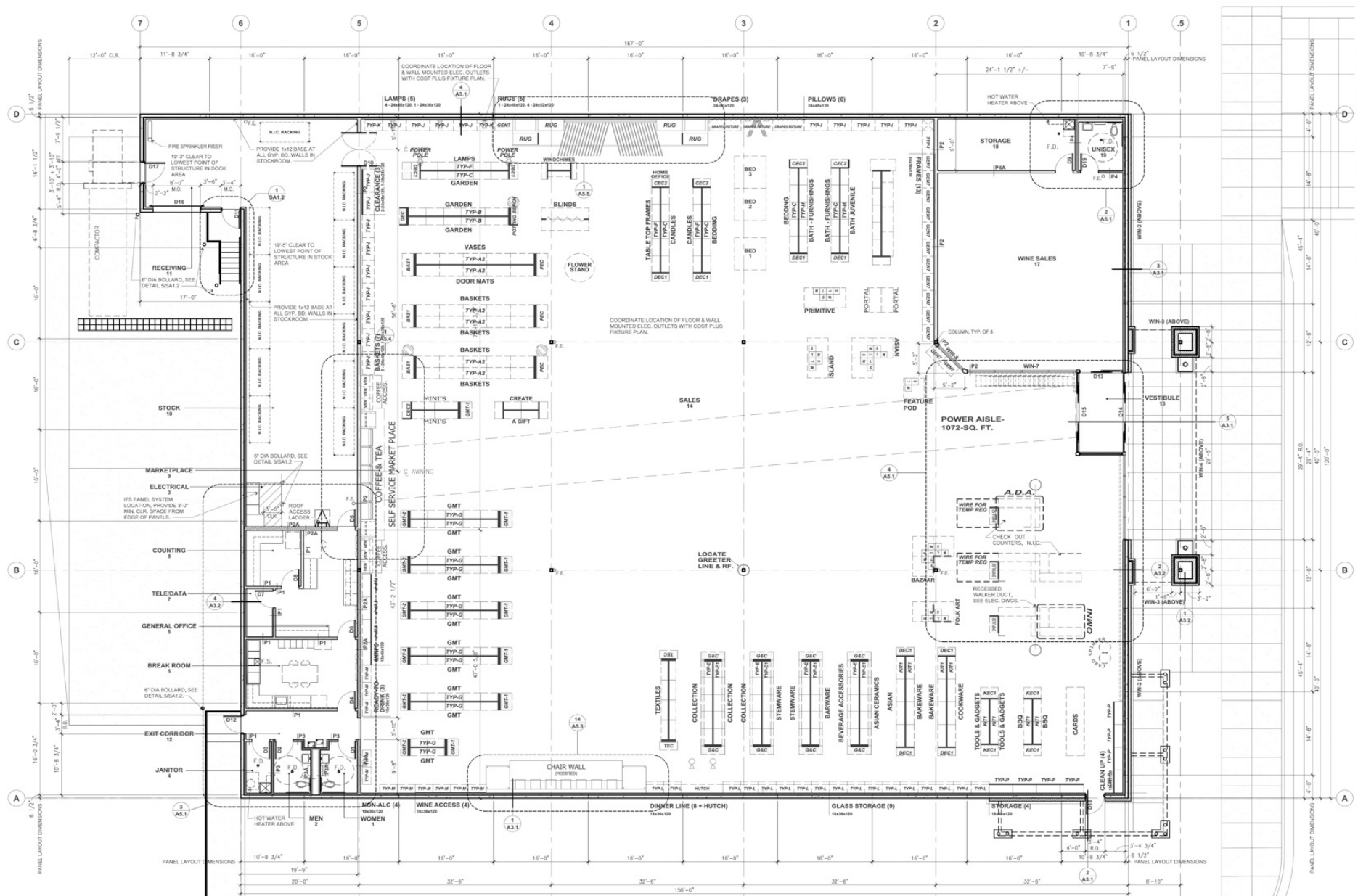

CLICK FOR VIDEO TOUR

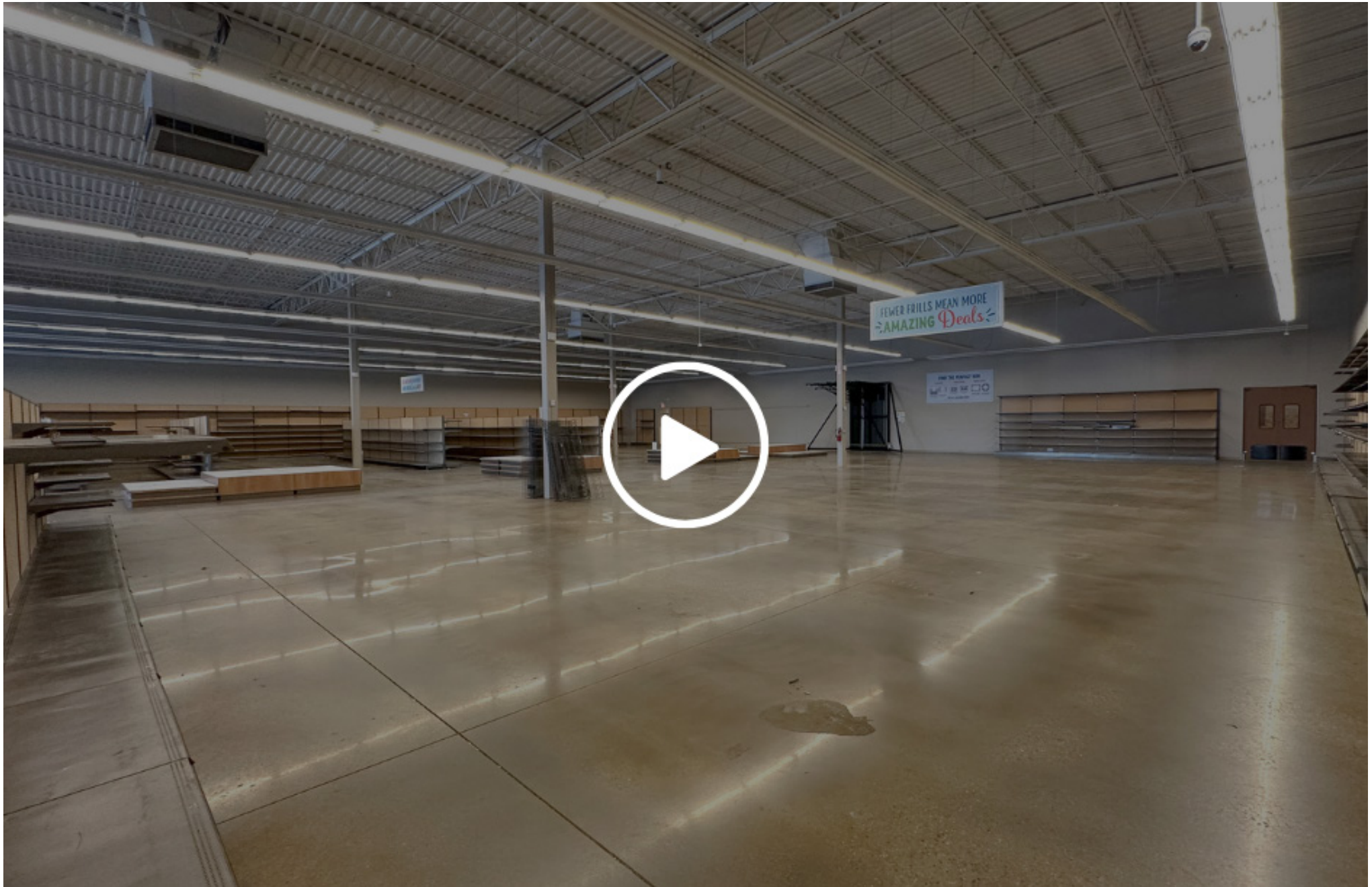

Offered by Landmark Commercial Real Estate and JLL Real Estate

# NORTHEAST DEVELOPMENTS



# AERIAL





LANDMARK  
COMMERCIAL  
REAL ESTATE

156 North Emporia  
Wichita, Kansas 67202  
[www.landmarkrealestate.net](http://www.landmarkrealestate.net)

For More Information:

Don Piros, CCIM  
Associate  
Office: 316-262-2442  
Mobile: 316-990-0606  
[dpiros@landmarkrealestate.net](mailto:dpiros@landmarkrealestate.net)

## ABOUT LANDMARK

Landmark Commercial Real Estate, Inc. has extensive experience in the leasing and sales of retail, office, restaurant and industrial properties, as well as property management. We represent both Owners and Tenants/Buyers. Our extensive experience with both sides of the transaction gives us added insight in negotiating transactions that work for both parties. Landmark Commercial Real Estate maintains a large property database, which we utilize to provide Tenants with quick and reliable information. Landmark is also experienced in all phases of commercial real estate development including evaluation, conception, site selection, site planning, developmental services, construction management and leasing.

Landmark prides itself on our success in focusing on leasing and marketing properties for sale, lease and development. Many of the properties we handle are owned by institutional owners, investors and developers, who demand a high level of reporting and results. We are selective in the Listings that we accept, and we provide a commitment to results through implementation of a strategic marketing plan on every property.

## DISCLAIMER

Information included herein was provided by third parties and should only be used for informational purposes. Landmark Commercial Real Estate, Inc and their respective agents, representatives, and employees, (i) make no representations or warranties of any kind, express or implied, with respect to the accuracy or completeness of any information included herein, and (ii) shall have no liability whatsoever arising from any errors or discrepancies between the above listed information and actual documents.