

RETAIL FOR LEASE

114 N 3RD ST | BISMARCK, ND





PROPERTY OVERVIEW

The historic Prince Hotel building offers both main floor commercial and upper floor residential opportunities. Store front located on 3rd Street offers high visibility, great signage, and shelled conditions for mixed use retail/professional services or a restaurant/lounge.

*Lease application may be required.

PROPERTY HIGHLIGHTS

- New store front with ample daylight windows
- Shelled condition
- Excellent signage
- 2 spaces available
- Located near parking ramp
- High traffic downtown area
- *Individual restroom build-out required per unit
- Taxes (2023): \$2,142.88
- Specials- Installments: \$143.99 / Balance: \$863.96

OFFERING SUMMARY

Lease Rate SF/Yr:	\$9.00 - 10.00 (NNN)
Lease Rate Monthly:	\$1,000 - \$2,861.67
Building Size:	35,413 SF
Available SF:	1,779 - 3,434 SF
Zoning:	DC
Tenant Responsibility:	Real Estate Taxes & Building Insurance (est. at \$0.74 PSF), Common Area Expenses, All Utilities, and Renter's Insurance
Landlord Responsibility:	Structural integrity of the exterior walls, roof, & foundation



AVAILABLE SPACES

SUITE	TENANT	SIZE (SF)	LEASE TYPE	LEASE RATE
Space 1	-	809 SF	NNN	Leased
Space 2	Available	1,779 SF	NNN	\$9.00 SF/yr
Space 3	Available	3,434 SF	NNN	\$10.00 SF/yr

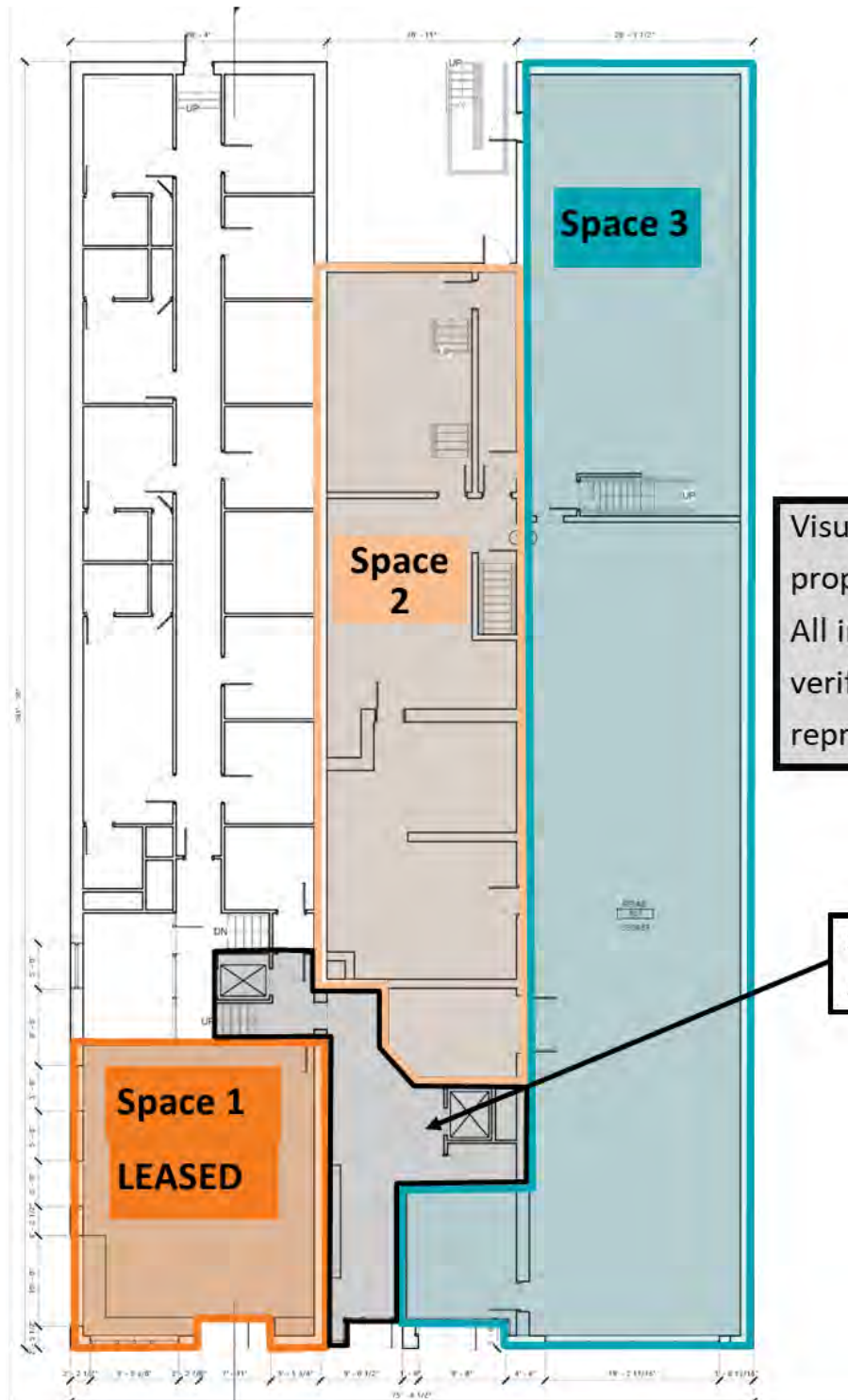

N 3RD ST





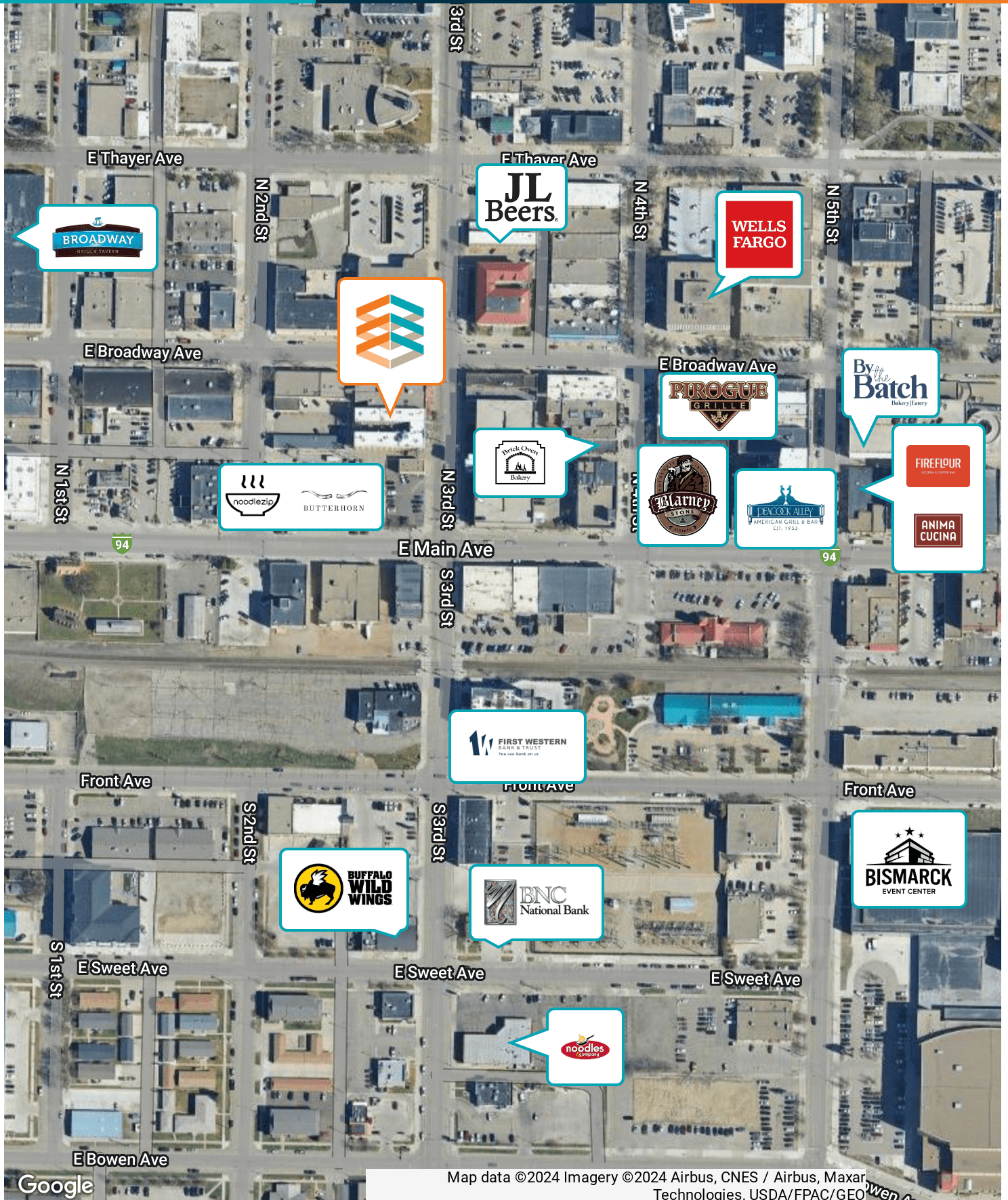

DOWNTOWN BISMARCK PARKING

MONTHLY AND HOURLY RATES

701-222-8954 FOR MORE INFO

THIRD & MAIN RAMP

- Monthly Rent Rates:
- Level 2 - Reserved \$75.00
- Covered Parking \$64.00
- Roof-top Parking \$40.00
- Nights: 4 PM to 4 AM \$26.00
- Hourly: \$1.50/hr or \$8/day



PARKADE: 6TH & BROADWAY

- Monthly Rent Rates:
- Covered Parking \$64.00
- Roof-top Parking \$40.00
- Nights: 4 PM to 4 AM \$26.00
- Hourly: \$1.50/hr or \$8/day



GALLERIA: 7TH & BROADWAY

- Monthly rent rate is \$64.00
- Hourly: \$1.50/hr or \$8/day



SIXTH & THAYER RAMP

- Monthly Rent Rates:
- Covered Parking \$64.00
- Roof-top Parking \$40.00
- Hourly: \$1.50/hr or \$8/day



Please visit the Parkade office, 114 N. 6th Street, to sign up for monthly parking. www.bismarckparkingauthority.com

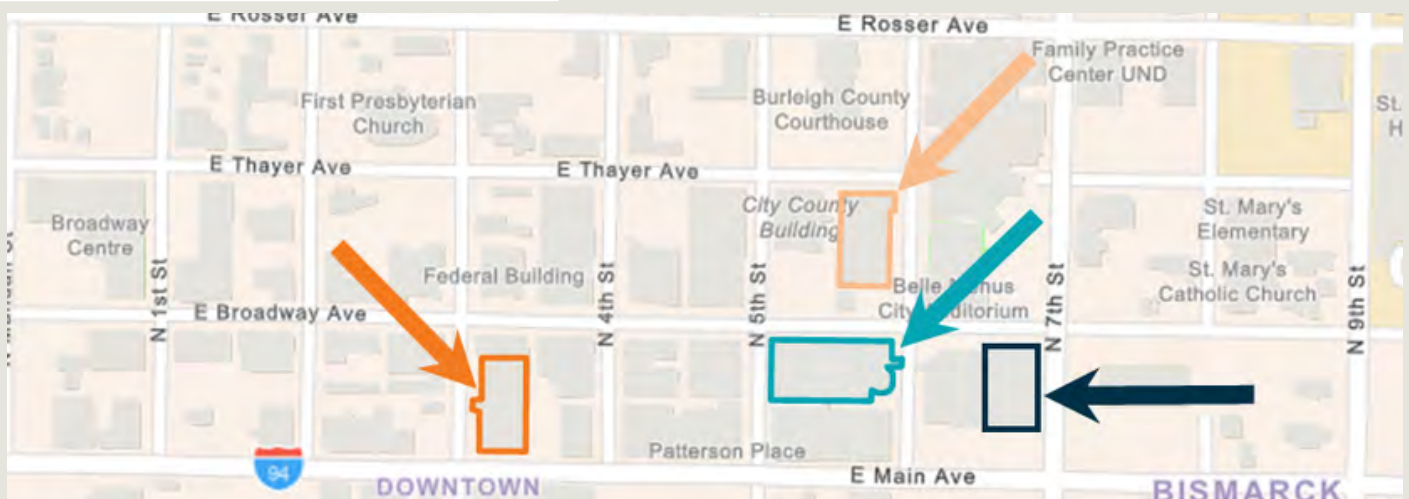

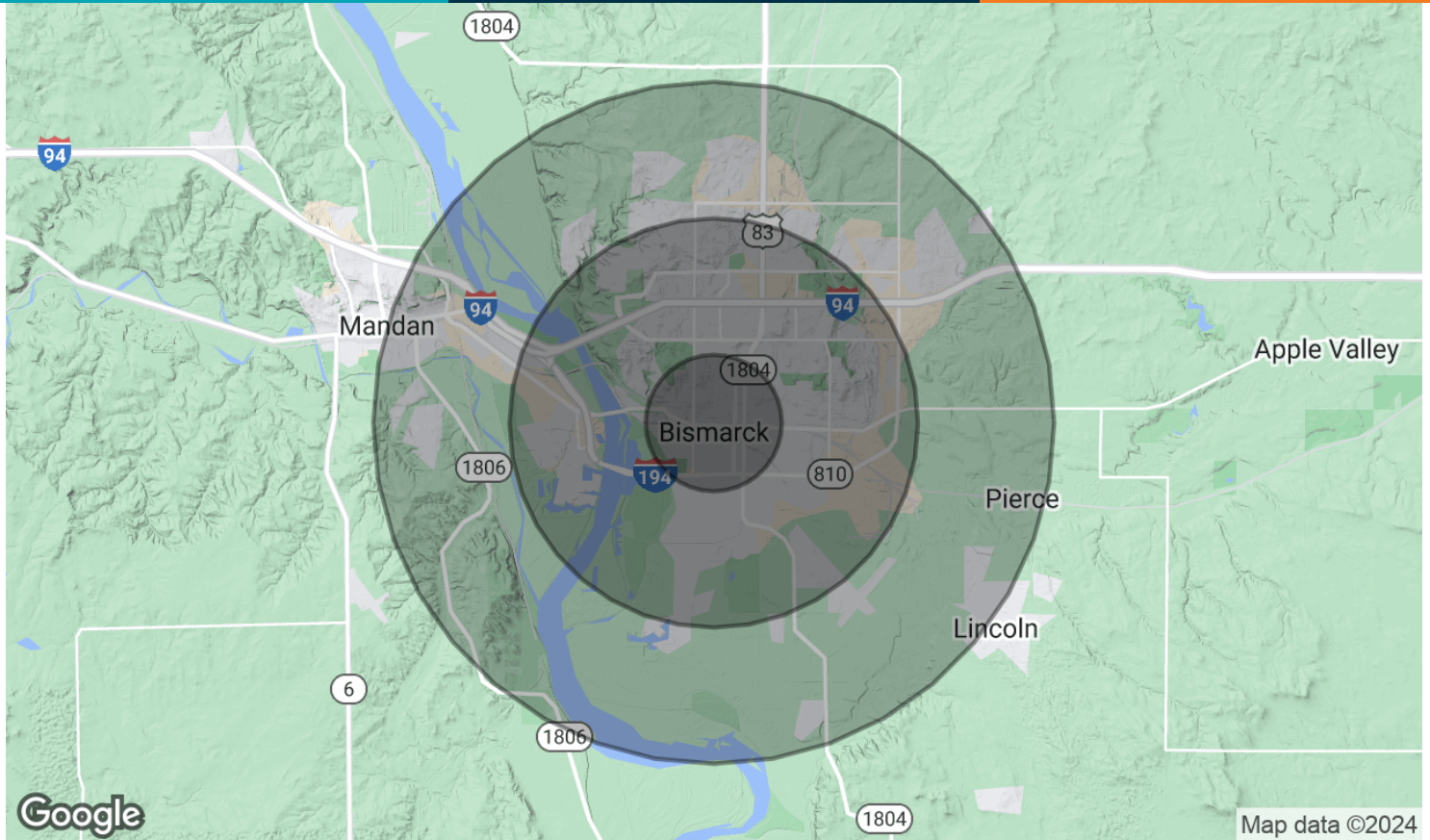

POPULATION	1 MILE	3 MILES	5 MILES
Total Population	11,181	63,362	86,882
Average Age	38.2	38.3	38.1
Average Age (Male)	38.1	36.2	35.9
Average Age (Female)	38.3	40.9	41.1

HOUSEHOLDS & INCOME	1 MILE	3 MILES	5 MILES
Total Households	5,473	28,889	38,199
# of Persons per HH	2.0	2.2	2.3
Average HH Income	\$47,919	\$57,366	\$63,134
Average House Value	\$143,501	\$140,828	\$148,119

* Demographic data derived from 2020 ACS - US Census



CRA

COMMERCIAL
REAL ESTATE
ADVISORS™

BUILDING RELATIONSHIPS.
BUILDING THE COMMUNITY.™



KYLE HOLWAGNER, CCIM, SIOR

Partner | Broker Associate
701.400.5373
kyle@thecragroup.com



KRISTYN STECKLER, COMMERCIAL REALTOR®

Partner | Broker
701.527.0138
kristyn@thecragroup.com



@THECRAGROUP

Although information has been obtained from sources deemed reliable, neither Owner nor CRA makes any guarantees, warranties, or representations, express or implied, as to the completeness or accuracy as to the information contained herein. You should conduct a careful, independent investigation of the property and verify all information. Any reliance on this information is solely at your own risk. The Property may be withdrawn without notice. Neither Owner nor CRA accepts any liability for any loss or damage suffered by any party resulting from reliance on this information. Photos, logos, and other images herein are the property of their respective owners. Use of these images without the express written consent of the owner is prohibited.