

**NOTES:**

1) SOIL BORINGS WERE LOCATED USING A SPECTRA PRECISION MOBILE MAPPER 120 GPS UNIT FROM THE REFERENCE POINT (RP1) AND VICKI LANE SHOWN ON THE DRAWING BELOW.

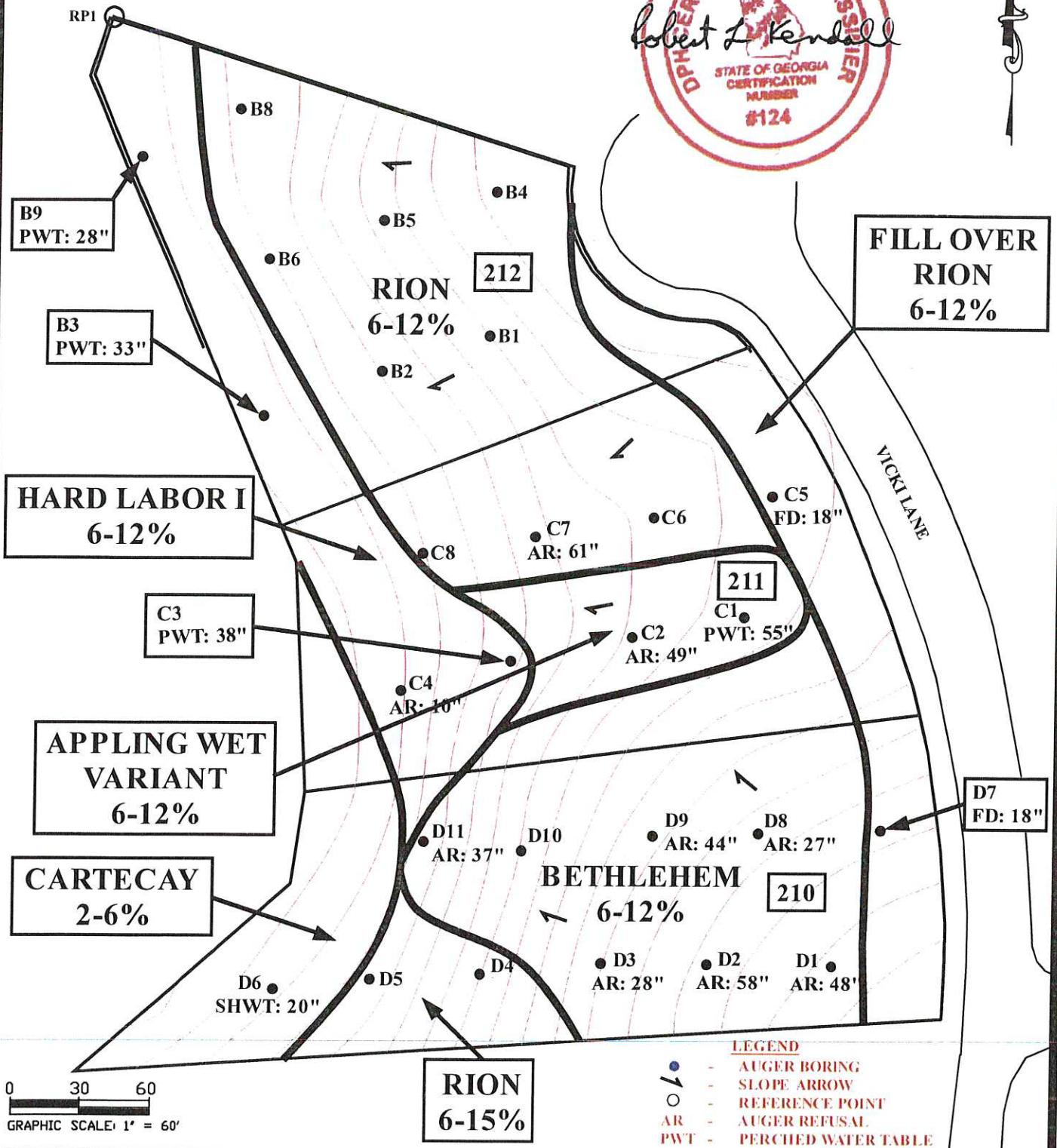

**LEVEL 4 SOIL MAP**  
**HAMBRICK CREEK S/D**  
**LOTS 210, 211, 212**  
**L.L. 131, 11TH DISTRICT**  
**HENRY COUNTY, GEORGIA**



**KENDALL & ASSOCIATES, INC.**

**Soil and Ecological Consultants**

2443 Powder Springs Road Marietta, Georgia 30064, (Ph.) 770-439-8824



# KENDALL & ASSOCIATES, INC.



**Soil and Ecological Consultants**

## SOIL INVESTIGATION REPORT

Report Date: 2/10/15      Inspection Dates: 2/5/15,      Level of Study: 4  
1/28/15, 1/14/15  
Site Location: Hambrick Creek S/D, Lots 210, 211,      Job No. 15000.1  
212, 213, 215, 216, 221 & 228  
Client: Dudley Freeman – Talon Homes      Phone: 404-391-3352  
County: Henry      Land Lot: 131      District: 11<sup>th</sup>  
Field Inspection By: Jeff Reichel & Christain Hoadley  
Boring Location Method: Pacing compass bearings from GIS-located reference points  
Certified By: Robert L. Kendall, BCSC



### SOIL INTERPRETIVE DATA

Soil Units	Slope (%)	Depth to Bedrock (in)	Depth to SHWT* (in)	Estimated Perc. (min/in)	Depth of Estimated Perc/(in)	Optimum Trench Depth (in)	Soil Suit. Code
Alcovy	2-6	>72	33	75	6-32	18-20	C1B
Appling Wet Variant	6-12	>72	55	70	12-42	24-30	P
Bethlehem	6-25	27-58**	>58	60	6-36	18-24	N6
Cartecay	2-6	>72	20	---	---	---	F2
Cecil	2-10	>72	>72	60	24-60	36-48	A
Colfax	6-12	>72	17	---	---	---	F3
Fill Over Rion	6-12	>72	>72	45	24-60	36-48	Q1
Hard Labor I	6-12	>72	33	75	6-32	18-20	C1B
Hard Labor II	6-12	>72	48	70	12-48	18-24	P
Madison	2-25	>72	>72	45	24-60	36-48	A
Pacolet	2-25	>72	>72	45	24-60	36-48	A
Rion	6-12	>72	>72	45	24-60	36-48	A
Starr	2-6	>72	>72	---	---	---	F4
Udorthent Fill	10-25	>48	>48	---	---	---	F5

\* Seasonal High Water Table

\*\* Auger refusal was encountered on hard weathered rock at depths ranging from 27 to 58 inches.



**SOIL SUITABILITY LEGEND  
LEVEL 4 SOIL MAPPING  
HAMBRICK CREEK S/D  
LOTS 210, 211, 212, 213, 215, 216, 221, 228  
L.L. 131, 11<sup>TH</sup> DISTRICT  
HENRY COUNTY, GEORGIA**

- A      Soils are typically suitable for conventional absorption field with proper design, installation and maintenance.
- C1B    Soils are unsuitable for conventional absorption fields due to seasonal perched water table conditions. Soils are generally suitable for shallow trench absorption fields with treatment system producing Class I effluent. The local Environmental Health Specialist must approve non-conventional system design and installation.
- F2      Soils are unsuitable for on-site wastewater disposal due to seasonal high water table.
- F3      Soils are unsuitable for on-site wastewater disposal due to shallow perched water table.
- F4      Soils are unsuitable for on-site wastewater disposal due to flooding and / or storm water drainage patterns.
- F5      Soil consists of poorly sorted fill that is unsuitable for on-site wastewater disposal.
- N6      Soils contain somewhat shallow parent material and partially weathered rock. Soils are generally suitable for conventional absorption field with shallow trench as recommended. Backhoe pits excavated during system installation may reveal absence of hard bedrock that would allow deeper trenches to be installed in this soil.
- P      Soils have a deep seasonal perched water table. Absorption trenches installed 24 inches above seasonal high water table should function effectively. Estimated percolation rate is for recommended trench depth. Some fill may need to be mounded over absorption field to divert storm water and provide adequate cover over trenches.
- Q1      Soils contain variable depth of fill over well drained upland soil. Absorption field should be installed so that chambers are entirely in natural soil. Estimated percolation rate is for natural soil underlying fill. Trench depth should be determined in the field after identifying greatest depth of fill within absorption field area.



**NOTES:**

1) SOIL BORINGS WERE LOCATED USING A SPECTRA PRECISION MOBILE MAPPER 120 GPS UNIT FROM THE REFERENCE POINT (RP1) AND VICKI LANE SHOWN ON THE DRAWING BELOW.

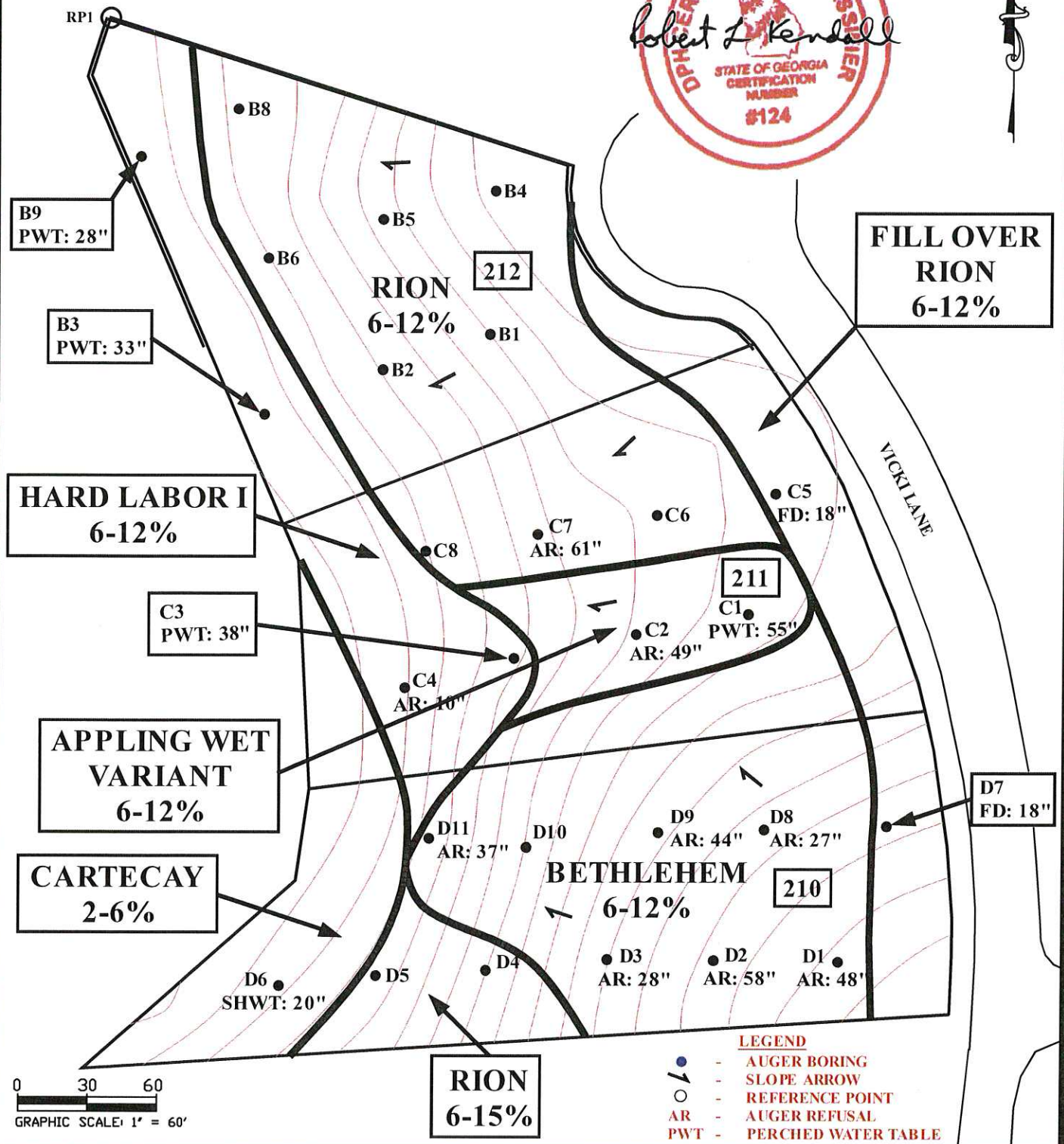

**LEVEL 4 SOIL MAP**  
**HAMBRICK CREEK S/D**  
**LOTS 210, 211, 212**  
**L.L. 131, 11TH DISTRICT**  
**HENRY COUNTY, GEORGIA**



**KENDALL & ASSOCIATES, INC.**

**Soil and Ecological Consultants**

2443 Powder Springs Road Marietta, Georgia 30064, (Ph.) 770-439-8824





Soil Units	Slope (%)	Depth to Bedrock (in)	Depth to SHWT* (in)	Estimated Perc. (min/in)	Depth of Estimated Perc/(in)	Optimum Trench Depth (in)	Soil Suit. Code
Alcovy	2-6	>72	33	75	6-32	18-20	C1B
Appling Wet Variant	6-12	>72	55	70	12-42	24-30	P
Bethlehem	6-25	27-58**	>58	60	6-36	18-24	N6
Cartecay	2-6	>72	20	---	---	---	F2
Cecil	2-10	>72	>72	60	24-60	36-48	A
Colfax	6-12	>72	17	---	---	---	F3
Fill Over Rion	6-12	>72	>72	45	24-60	36-48	Q1
Hard Labor I	6-12	>72	33	75	6-32	18-20	C1B
Hard Labor II	6-12	>72	48	70	12-48	18-24	P
Madison	2-25	>72	>72	45	24-60	36-48	A
Pacolet	2-25	>72	>72	45	24-60	36-48	A
Rion	6-12	>72	>72	45	24-60	36-48	A
Starr	2-6	>72	>72	---	---	---	F4
Udorthent Fill	10-25	>48	>48	---	---	---	F5

\*\*Auger refusal was encountered on hard weathered rock at depths ranging from 27 to 58 inches.

**SOIL SUITABILITY LEGEND  
LEVEL 4 SOIL MAPPING  
HAMBRICK CREEK S/D  
LOTS 210, 211, 212, 213, 215, 216, 221, 228  
L.L. 131, 11<sup>TH</sup> DISTRICT  
HENRY COUNTY, GEORGIA**

- A Soils are typically suitable for conventional absorption field with proper design, installation and maintenance.
- C1B Soils are unsuitable for conventional absorption fields due to seasonal perched water table conditions. Soils are generally suitable for shallow trench absorption fields with treatment system producing Class I effluent. The local Environmental Health Specialist must approve non-conventional system design and installation.
- F2 Soils are unsuitable for on-site wastewater disposal due to seasonal high water table.
- F3 Soils are unsuitable for on-site wastewater disposal due to shallow perched water table.
- F4 Soils are unsuitable for on-site wastewater disposal due to flooding and / or storm water drainage patterns.
- F5 Soil consists of poorly sorted fill that is unsuitable for on-site wastewater disposal.
- N6 Soils contain somewhat shallow parent material and partially weathered rock. Soils are generally suitable for conventional absorption field with shallow trench as recommended. Backhoe pits excavated during system installation may reveal absence of hard bedrock that would allow deeper trenches to be installed in this soil.
- P Soils have a deep seasonal perched water table. Absorption trenches installed 24 inches above seasonal high water table should function effectively. Estimated percolation rate is for recommended trench depth. Some fill may need to be mounded over absorption field to divert storm water and provide adequate cover over trenches.
- Q1 Soils contain variable depth of fill over well drained upland soil. Absorption field should be installed so that chambers are entirely in natural soil. Estimated percolation rate is for natural soil underlying fill. Trench depth should be determined in the field after identifying greatest depth of fill within absorption field area.





**NOTES:**

1) SOIL BORINGS WERE LOCATED USING A SPECTRA PRECISION MOBILE MAPPER 120 GPS UNIT FROM THE REFERENCE POINT (RP1) AND VICKI LANE SHOWN ON THE DRAWING BELOW. SOIL BORINGS AT G1 - G13 WERE ADVANCED BY K&A ON 2/5/2015. ALL OTHER SOIL BORINGS ARE FROM THE ORIGINAL GSM L3 INVESTIGATION.

**PACOLET FROM GSM LEVEL 3**

**SAW/RAWLINGS FROM GSM LEVEL 3**

**LIMIT OF LEVEL 4 STUDY**



**PACOLET 15-25%**

**LEGEND**

- - AUGER BORING
- - BACKHOE PIT
- - REFERENCE POINT
- ↘ - SLOPE ARROW
- AR - AUGER REFUSAL
- BT - BORING TERMINATION

**BETHLEHEM 15-25%**

**MADISON 15-25%**

**UDORTHEM FILL 10-25%**

RP1

BB2

G12

G11  
AA2

G7  
AR: 40"

G6  
AR: 53"

G8  
AR: 35"

G9  
AR: 47"

C2  
AR: 26"

D2  
AR: 22"

C3  
AR: 52"

B.3 G4

G5  
AR: 30"

G10  
AR: 36"

G13  
BT: 48"

50' STREAM BUFFER

VICKI L AVE

0 30 60  
GRAPHIC SCALE: 1" = 60'

**LEVEL 4 SOIL MAP  
HAMBRICK CREEK S/D  
LOT 228  
L.L. 131, 11TH DISTRICT  
HENRY COUNTY, GEORGIA**



**KENDALL & ASSOCIATES, INC.**

Soil and Ecological Consultants  
2443 Powder Springs Road Marietta, Georgia 30064, (Ph.) 770-439-8824



## Soil and Ecological Consultants

Robert L Kendall

Soil Units	Slope (%)	Depth to Bedrock (in)	Depth to SHWT* (in)	Estimated Perc. (min/in)	Depth of Estimated Perc/(in)	Optimum Trench Depth (in)	Soil Suit. Code
Alcovy	2-6	>72	33	75	6-32	18-20	C1B
Appling Wet Variant	6-12	>72	55	70	12-42	24-30	P
Bethlehem	6-25	27-58**	>58	60	6-36	18-24	N6
Cartecay	2-6	>72	20	---	---	---	F2
Cecil	2-10	>72	>72	60	24-60	36-48	A
Colfax	6-12	>72	17	---	---	---	F3
Fill Over Rion	6-12	>72	>72	45	24-60	36-48	Q1
Hard Labor I	6-12	>72	33	75	6-32	18-20	C1B
Hard Labor II	6-12	>72	48	70	12-48	18-24	P
Madison	2-25	>72	>72	45	24-60	36-48	A
Pacolet	2-25	>72	>72	45	24-60	36-48	A
Rion	6-12	>72	>72	45	24-60	36-48	A
Starr	2-6	>72	>72	---	---	---	F4
Udorthent Fill	10-25	>48	>48	---	---	---	F5

\*\*Auger refusal was encountered on hard weathered rock at depths ranging from 27 to 58 inches.



**SOIL SUITABILITY LEGEND  
LEVEL 4 SOIL MAPPING  
HAMBRICK CREEK S/D  
LOTS 210, 211, 212, 213, 215, 216, 221, 228  
L.L. 131, 11<sup>TH</sup> DISTRICT  
HENRY COUNTY, GEORGIA**

- A      Soils are typically suitable for conventional absorption field with proper design, installation and maintenance.
- C1B    Soils are unsuitable for conventional absorption fields due to seasonal perched water table conditions. Soils are generally suitable for shallow trench absorption fields with treatment system producing Class I effluent. The local Environmental Health Specialist must approve non-conventional system design and installation.
- F2      Soils are unsuitable for on-site wastewater disposal due to seasonal high water table.
- F3      Soils are unsuitable for on-site wastewater disposal due to shallow perched water table.
- F4      Soils are unsuitable for on-site wastewater disposal due to flooding and / or storm water drainage patterns.
- F5      Soil consists of poorly sorted fill that is unsuitable for on-site wastewater disposal.
- N6      Soils contain somewhat shallow parent material and partially weathered rock. Soils are generally suitable for conventional absorption field with shallow trench as recommended. Backhoe pits excavated during system installation may reveal absence of hard bedrock that would allow deeper trenches to be installed in this soil.
- P      Soils have a deep seasonal perched water table. Absorption trenches installed 24 inches above seasonal high water table should function effectively. Estimated percolation rate is for recommended trench depth. Some fill may need to be mounded over absorption field to divert storm water and provide adequate cover over trenches.
- Q1      Soils contain variable depth of fill over well drained upland soil. Absorption field should be installed so that chambers are entirely in natural soil. Estimated percolation rate is for natural soil underlying fill. Trench depth should be determined in the field after identifying greatest depth of fill within absorption field area.



NOTES:

1) SOIL BORINGS WERE LOCATED USING A SPECTRA PRECISION MOBILE MAPPER 120 GPS UNIT FROM THE REFERENCE POINTS (RP) AND VICKI LANE SHOWN ON THE DRAWING BELOW.

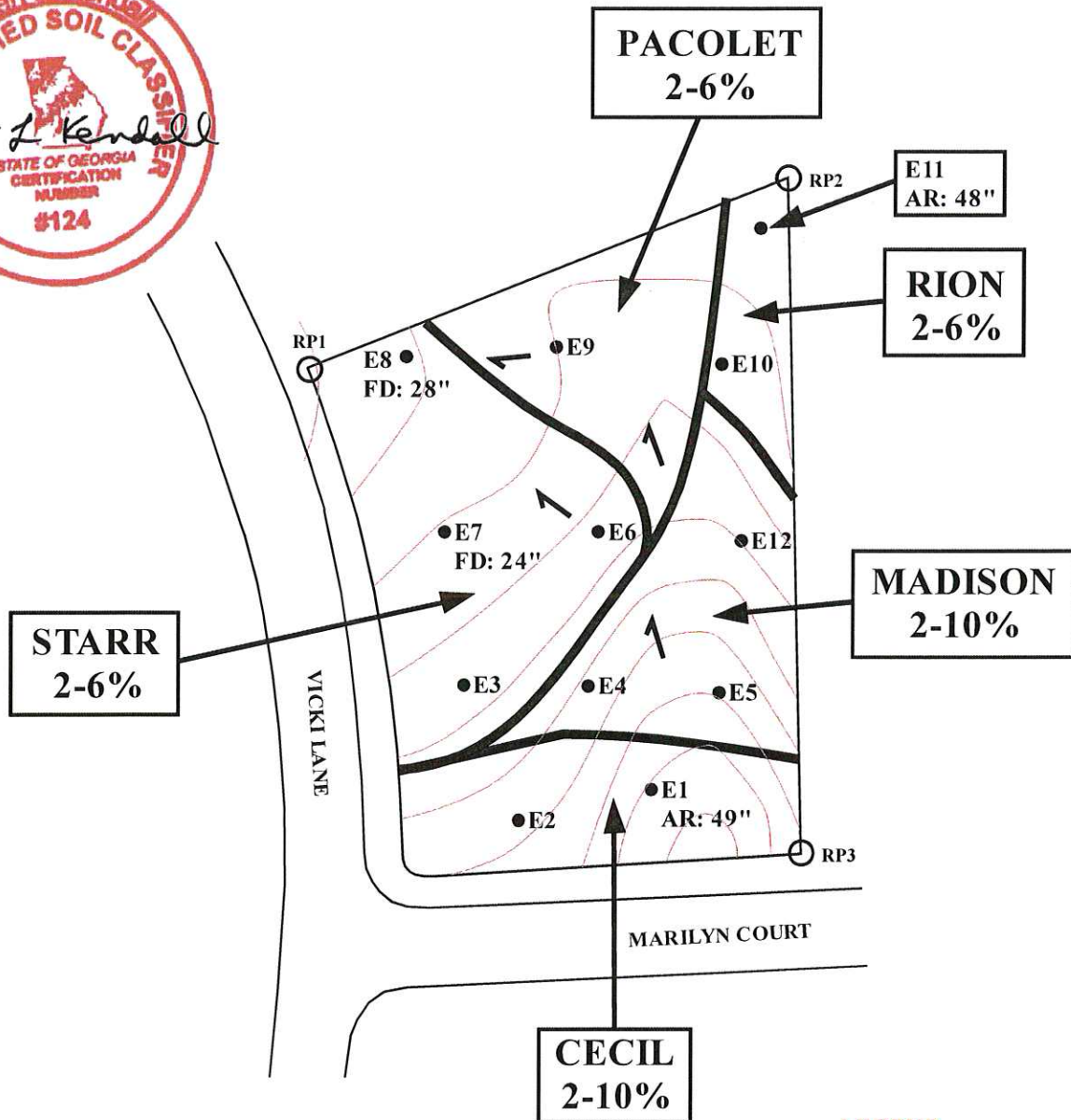

**LEGEND**

- - AUGER BORING
- ↗ - SLOPE ARROW
- - REFERENCE POINT
- AR - AUGER REFUSAL
- FD - FILL DEPTH

0 30 60  
GRAPHIC SCALE: 1" = 60'

LEVEL 4 SOIL MAP  
409 MARILYN COURT  
HAMBRICK CREEK S/D, LOT 216  
L.L. 131, 11TH DISTRICT  
HENRY COUNTY, GEORGIA



**KENDALL & ASSOCIATES, INC.**

Soil and Ecological Consultants

2443 Powder Springs Road Marietta, Georgia 30064, (Ph.) 770-439-8824



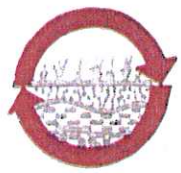

# KENDALL & ASSOCIATES, INC.

Soil and Ecological Consultants

## SOIL INVESTIGATION REPORT

Report Date: 2/10/15      Inspection Dates: 2/5/15,      Level of Study: 4  
1/28/15, 1/14/15  
Site Location: Hambrick Creek S/D, Lots 210, 211,      Job No. 15000.1  
212, 213, 215, 216, 221 & 228  
Client: Dudley Freeman – Talon Homes      Phone: 404-391-3352  
County: Henry      Land Lot: 131      District: 11<sup>th</sup>  
Field Inspection By: Jeff Reichel & Christain Hoadley  
Boring Location Method: Pacing compass bearings from GIS-located reference points  
Certified By: Robert L. Kendall, BCSC



## SOIL INTERPRETIVE DATA

Soil Units	Slope (%)	Depth to Bedrock (in)	Depth to SHWT* (in)	Estimated Perc. (min/in)	Depth of Estimated Perc/(in)	Optimum Trench Depth (in)	Soil Suit. Code
Alcovy	2-6	>72	33	75	6-32	18-20	C1B
Appling Wet Variant	6-12	>72	55	70	12-42	24-30	P
Bethlehem	6-25	27-58**	>58	60	6-36	18-24	N6
Cartecay	2-6	>72	20	---	---	---	F2
Cecil	2-10	>72	>72	60	24-60	36-48	A
Colfax	6-12	>72	17	---	---	---	F3
Fill Over Rion	6-12	>72	>72	45	24-60	36-48	Q1
Hard Labor I	6-12	>72	33	75	6-32	18-20	C1B
Hard Labor II	6-12	>72	48	70	12-48	18-24	P
Madison	2-25	>72	>72	45	24-60	36-48	A
Pacolet	2-25	>72	>72	45	24-60	36-48	A
Rion	6-12	>72	>72	45	24-60	36-48	A
Starr	2-6	>72	>72	---	---	---	F4
Udorthent Fill	10-25	>48	>48	---	---	---	F5

\* Seasonal High Water Table

\*\*Auger refusal was encountered on hard weathered rock at depths ranging from 27 to 58 inches.

**SOIL SUITABILITY LEGEND  
LEVEL 4 SOIL MAPPING  
HAMBRICK CREEK S/D  
LOTS 210, 211, 212, 213, 215, 216, 221, 228  
L.L. 131, 11<sup>TH</sup> DISTRICT  
HENRY COUNTY, GEORGIA**

- A      Soils are typically suitable for conventional absorption field with proper design, installation and maintenance.
  
- C1B    Soils are unsuitable for conventional absorption fields due to seasonal perched water table conditions. Soils are generally suitable for shallow trench absorption fields with treatment system producing Class I effluent. The local Environmental Health Specialist must approve non-conventional system design and installation.
  
- F2      Soils are unsuitable for on-site wastewater disposal due to seasonal high water table.
  
- F3      Soils are unsuitable for on-site wastewater disposal due to shallow perched water table.
  
- F4      Soils are unsuitable for on-site wastewater disposal due to flooding and / or storm water drainage patterns.
  
- F5      Soil consists of poorly sorted fill that is unsuitable for on-site wastewater disposal.
  
- N6      Soils contain somewhat shallow parent material and partially weathered rock. Soils are generally suitable for conventional absorption field with shallow trench as recommended. Backhoe pits excavated during system installation may reveal absence of hard bedrock that would allow deeper trenches to be installed in this soil.
  
- P      Soils have a deep seasonal perched water table. Absorption trenches installed 24 inches above seasonal high water table should function effectively. Estimated percolation rate is for recommended trench depth. Some fill may need to be mounded over absorption field to divert storm water and provide adequate cover over trenches.
  
- Q1      Soils contain variable depth of fill over well drained upland soil. Absorption field should be installed so that chambers are entirely in natural soil. Estimated percolation rate is for natural soil underlying fill. Trench depth should be determined in the field after identifying greatest depth of fill within absorption field area.





NOTES:

1) SOIL BORINGS WERE LOCATED USING A SPECTRA PRECISION MOBILE MAPPER 120 GPS UNIT FROM THE REFERENCE POINT (RP1) AND VICKI LANE SHOWN ON THE DRAWING BELOW.

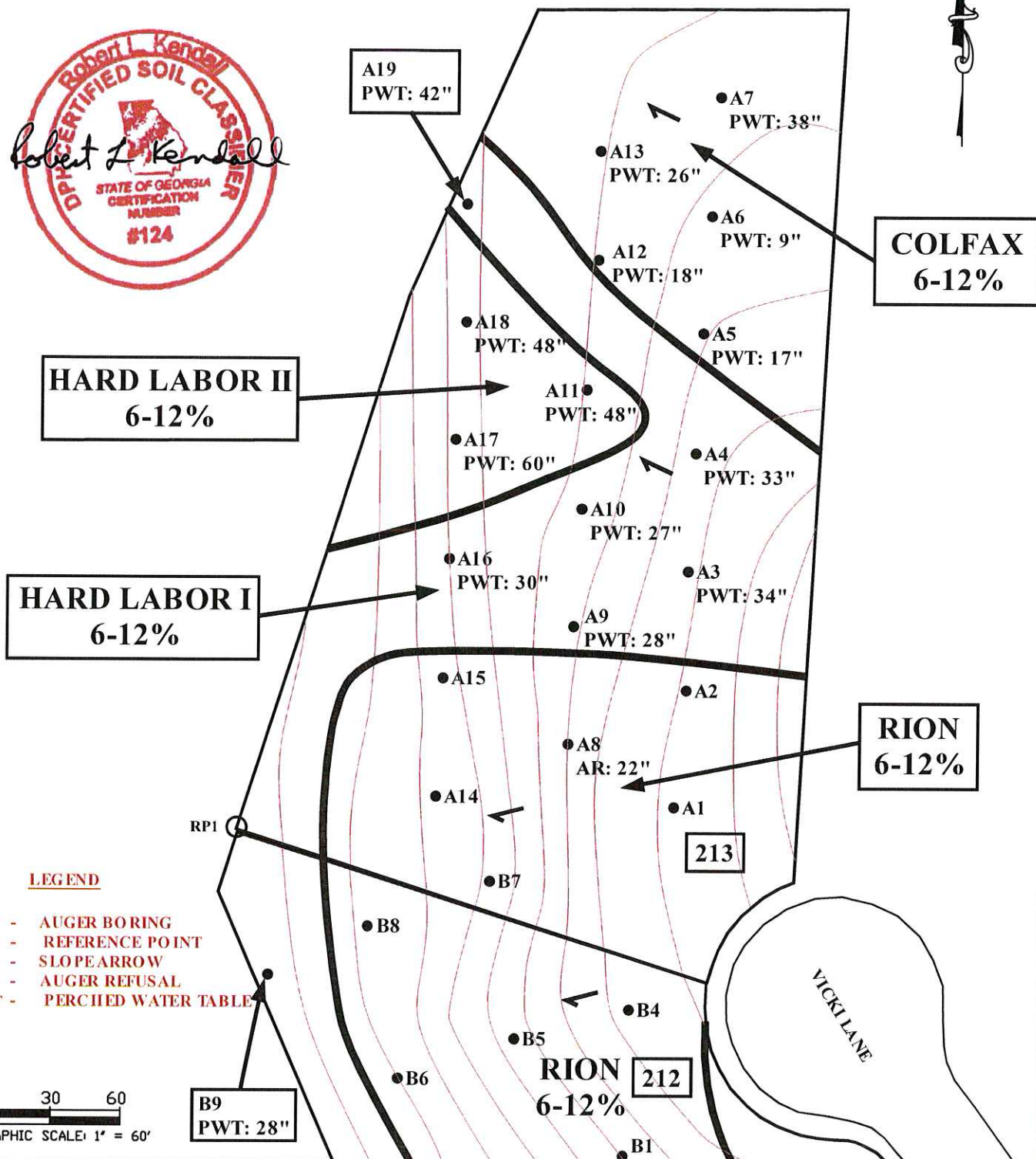

LEVEL 4 SOIL MAP  
HAMBRICK CREEK S/D  
LOT 213  
L.L. 131, 11TH DISTRICT  
HENRY COUNTY, GEORGIA



**KENDALL & ASSOCIATES, INC.**

Soil and Ecological Consultants

2443 Powder Springs Road Marietta, Georgia 30064, (Ph.) 770-439-8824



# KENDALL & ASSOCIATES, INC.

Soil and Ecological Consultants



## SOIL INVESTIGATION REPORT

Report Date: 2/10/15 Inspection Dates: 2/5/15, 1/28/15, 1/14/15 Level of Study: 4

Site Location: Hambrick Creek S/D, Lots 210, 211, 212, 213, 215, 216, 221 & 228 Job No. 15000.1

Client: Dudley Freeman – Talon Homes Phone: 404-391-3352  
County: Henry Land Lot: 131 District: 11<sup>th</sup>

Field Inspection By: Jeff Reichel & Christain Hoadley

Boring Location Method: Pacing compass bearings from GIS-located reference points

Certified By: Robert L. Kendall, BCSC



## SOIL INTERPRETIVE DATA

Soil Units	Slope (%)	Depth to Bedrock (in)	Depth to SHWT* (in)	Estimated Perc. (min/in)	Depth of Estimated Perc/(in)	Optimum Trench Depth (in)	Soil Suit. Code
Alcovy	2-6	>72	33	75	6-32	18-20	C1B
Appling Wet Variant	6-12	>72	55	70	12-42	24-30	P
Bethlehem	6-25	27-58**	>58	60	6-36	18-24	N6
Cartecay	2-6	>72	20	---	---	---	F2
Cecil	2-10	>72	>72	60	24-60	36-48	A
Colfax	6-12	>72	17	---	---	---	F3
Fill Over Rion	6-12	>72	>72	45	24-60	36-48	Q1
Hard Labor I	6-12	>72	33	75	6-32	18-20	C1B
Hard Labor II	6-12	>72	48	70	12-48	18-24	P
Madison	2-25	>72	>72	45	24-60	36-48	A
Pacolet	2-25	>72	>72	45	24-60	36-48	A
Rion	6-12	>72	>72	45	24-60	36-48	A
Starr	2-6	>72	>72	---	---	---	F4
Udorthent Fill	10-25	>48	>48	---	---	---	F5

\* Seasonal High Water Table

\*\*Auger refusal was encountered on hard weathered rock at depths ranging from 27 to 58 inches.



**SOIL SUITABILITY LEGEND  
LEVEL 4 SOIL MAPPING  
HAMBRICK CREEK S/D  
LOTS 210, 211, 212, 213, 215, 216, 221, 228  
L.L. 131, 11<sup>TH</sup> DISTRICT  
HENRY COUNTY, GEORGIA**

- A Soils are typically suitable for conventional absorption field with proper design, installation and maintenance.
- C1B Soils are unsuitable for conventional absorption fields due to seasonal perched water table conditions. Soils are generally suitable for shallow trench absorption fields with treatment system producing Class I effluent. The local Environmental Health Specialist must approve non-conventional system design and installation.
- F2 Soils are unsuitable for on-site wastewater disposal due to seasonal high water table.
- F3 Soils are unsuitable for on-site wastewater disposal due to shallow perched water table.
- F4 Soils are unsuitable for on-site wastewater disposal due to flooding and / or storm water drainage patterns.
- F5 Soil consists of poorly sorted fill that is unsuitable for on-site wastewater disposal.
- N6 Soils contain somewhat shallow parent material and partially weathered rock. Soils are generally suitable for conventional absorption field with shallow trench as recommended. Backhoe pits excavated during system installation may reveal absence of hard bedrock that would allow deeper trenches to be installed in this soil.
- P Soils have a deep seasonal perched water table. Absorption trenches installed 24 inches above seasonal high water table should function effectively. Estimated percolation rate is for recommended trench depth. Some fill may need to be mounded over absorption field to divert storm water and provide adequate cover over trenches.
- Q1 Soils contain variable depth of fill over well drained upland soil. Absorption field should be installed so that chambers are entirely in natural soil. Estimated percolation rate is for natural soil underlying fill. Trench depth should be determined in the field after identifying greatest depth of fill within absorption field area.



**NOTES:**

1) SOIL BORINGS WERE LOCATED USING A SPECTRA PRECISION MOBILE MAPPER 120 GPS UNIT FROM THE REFERENCE POINT (RP1) AND VICKI LANE SHOWN ON THE DRAWING BELOW.

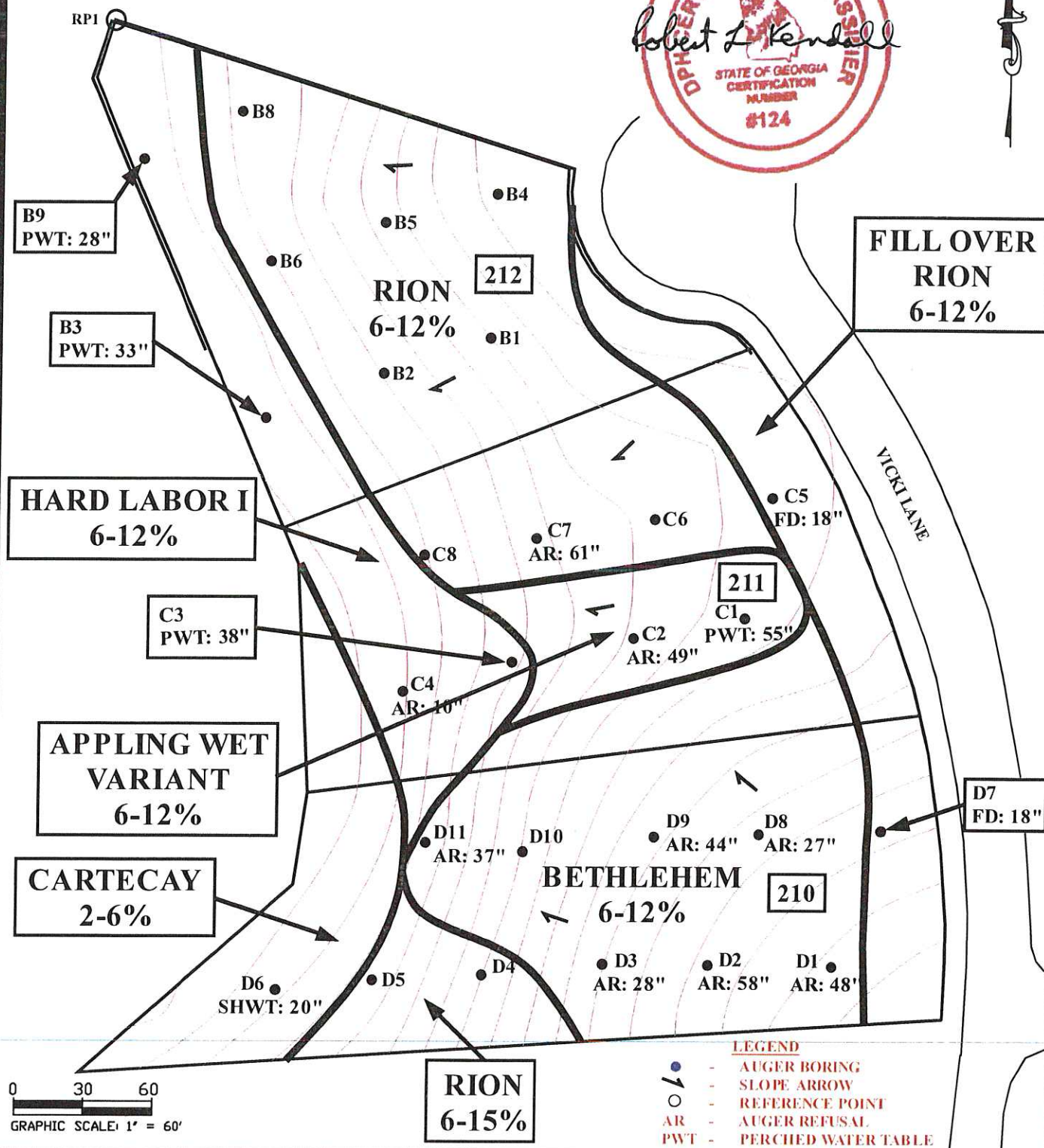

**LEVEL 4 SOIL MAP**  
**HAMBRICK CREEK S/D**  
**LOTS 210, 211, 212**  
**L.L. 131, 11TH DISTRICT**  
**HENRY COUNTY, GEORGIA**



**KENDALL & ASSOCIATES, INC.**

**Soil and Ecological Consultants**

2443 Powder Springs Road Marietta, Georgia 30064, (Ph.) 770-439-8824





# KENDALL & ASSOCIATES, INC.



**Soil and Ecological Consultants**

## SOIL INVESTIGATION REPORT

Report Date: 2/10/15      Inspection Dates: 2/5/15,      Level of Study: 4  
1/28/15, 1/14/15

Site Location: Hambrick Creek S/D, Lots 210, 211,      Job No. 15000.1  
212, 213, 215, 216, 221 & 228

Client: Dudley Freeman – Talon Homes      Phone: 404-391-3352

County: Henry      Land Lot: 131      District: 11<sup>th</sup>

Field Inspection By: Jeff Reichel & Christain Hoadley

Boring Location Method: Pacing compass bearings from GIS-located reference points

Certified By: Robert L. Kendall, BCSC



## SOIL INTERPRETIVE DATA

Soil Units	Slope (%)	Depth to Bedrock (in)	Depth to SHWT* (in)	Estimated Perc. (min/in)	Depth of Estimated Perc/(in)	Optimum Trench Depth (in)	Soil Suit. Code
Alcovy	2-6	>72	33	75	6-32	18-20	C1B
Appling Wet Variant	6-12	>72	55	70	12-42	24-30	P
Bethlehem	6-25	27-58**	>58	60	6-36	18-24	N6
Cartecay	2-6	>72	20	---	---	---	F2
Cecil	2-10	>72	>72	60	24-60	36-48	A
Colfax	6-12	>72	17	---	---	---	F3
Fill Over Rion	6-12	>72	>72	45	24-60	36-48	Q1
Hard Labor I	6-12	>72	33	75	6-32	18-20	C1B
Hard Labor II	6-12	>72	48	70	12-48	18-24	P
Madison	2-25	>72	>72	45	24-60	36-48	A
Pacolet	2-25	>72	>72	45	24-60	36-48	A
Rion	6-12	>72	>72	45	24-60	36-48	A
Starr	2-6	>72	>72	---	---	---	F4
Udorthent Fill	10-25	>48	>48	---	---	---	F5

\* Seasonal High Water Table

\*\*Auger refusal was encountered on hard weathered rock at depths ranging from 27 to 58 inches.

**SOIL SUITABILITY LEGEND  
LEVEL 4 SOIL MAPPING  
HAMBRICK CREEK S/D  
LOTS 210, 211, 212, 213, 215, 216, 221, 228  
L.L. 131, 11<sup>TH</sup> DISTRICT  
HENRY COUNTY, GEORGIA**

- A      Soils are typically suitable for conventional absorption field with proper design, installation and maintenance.
- C1B    Soils are unsuitable for conventional absorption fields due to seasonal perched water table conditions. Soils are generally suitable for shallow trench absorption fields with treatment system producing Class I effluent. The local Environmental Health Specialist must approve non-conventional system design and installation.
- F2      Soils are unsuitable for on-site wastewater disposal due to seasonal high water table.
- F3      Soils are unsuitable for on-site wastewater disposal due to shallow perched water table.
- F4      Soils are unsuitable for on-site wastewater disposal due to flooding and / or storm water drainage patterns.
- F5      Soil consists of poorly sorted fill that is unsuitable for on-site wastewater disposal.
- N6      Soils contain somewhat shallow parent material and partially weathered rock. Soils are generally suitable for conventional absorption field with shallow trench as recommended. Backhoe pits excavated during system installation may reveal absence of hard bedrock that would allow deeper trenches to be installed in this soil.
- P      Soils have a deep seasonal perched water table. Absorption trenches installed 24 inches above seasonal high water table should function effectively. Estimated percolation rate is for recommended trench depth. Some fill may need to be mounded over absorption field to divert storm water and provide adequate cover over trenches.
- Q1      Soils contain variable depth of fill over well drained upland soil. Absorption field should be installed so that chambers are entirely in natural soil. Estimated percolation rate is for natural soil underlying fill. Trench depth should be determined in the field after identifying greatest depth of fill within absorption field area.





NOTES:

1) SOIL BORINGS WERE LOCATED USING A SPECTRA PRECISION MOBILE MAPPER 120 GPS UNIT FROM THE REFERENCE POINTS (RP1 & RP2) AND MARILYN COURT SHOWN ON THE DRAWING BELOW.

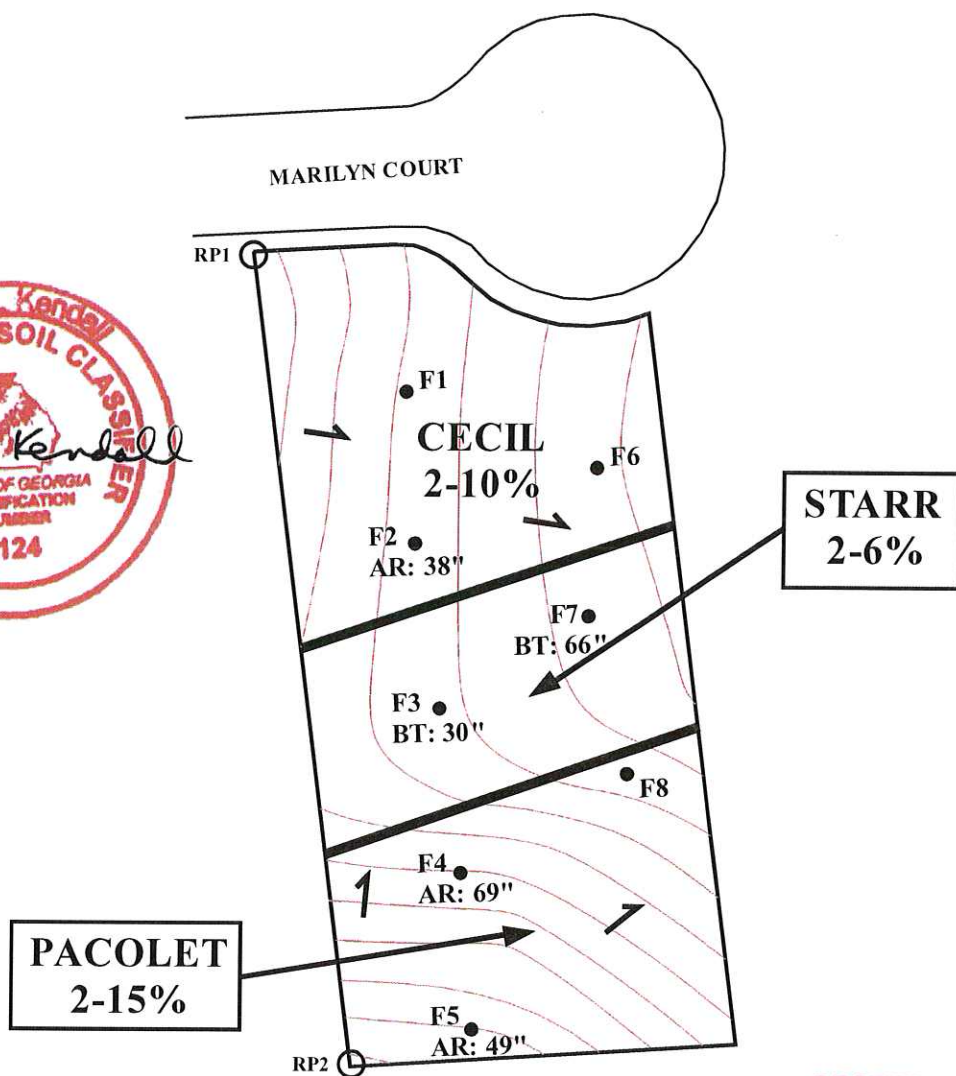

LEGEND

- - AUGER BORING
- ↗ - SLOPE ARROW
- - REFERENCE POINT
- AR - AUGER REFUSAL
- BT - BORING TERMINATION

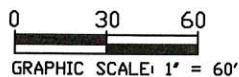

LEVEL 4 SOIL MAP  
HAMBRICK CREEK S/D  
LOT 221  
L.L. 131, 11TH DISTRICT  
HENRY COUNTY, GEORGIA



**KENDALL & ASSOCIATES, INC.**

Soil and Ecological Consultants  
2443 Powder Springs Road Marietta, Georgia 30064, (Ph.) 770-439-8824



# KENDALL & ASSOCIATES, INC.

Soil and Ecological Consultants



## SOIL INVESTIGATION REPORT

Report Date: 2/10/15 Inspection Dates: 2/5/15, 1/28/15, 1/14/15 Level of Study: 4

Site Location: Hambrick Creek S/D, Lots 210, 211, 212, 213, 215, 216, 221 & 228 Job No. 15000.1

Client: Dudley Freeman – Talon Homes Phone: 404-391-3352  
County: Henry Land Lot: 131 District: 11<sup>th</sup>

Field Inspection By: Jeff Reichel & Christain Hoadley

Boring Location Method: Pacing compass bearings from GIS-located reference points

Certified By: Robert L. Kendall, BCSC



## SOIL INTERPRETIVE DATA

Soil Units	Slope (%)	Depth to Bedrock (in)	Depth to SHWT* (in)	Estimated Perc. (min/in)	Depth of Estimated Perc/(in)	Optimum Trench Depth (in)	Soil Suit. Code
Alcovy	2-6	>72	33	75	6-32	18-20	C1B
Appling Wet Variant	6-12	>72	55	70	12-42	24-30	P
Bethlehem	6-25	27-58**	>58	60	6-36	18-24	N6
Cartecay	2-6	>72	20	---	---	---	F2
Cecil	2-10	>72	>72	60	24-60	36-48	A
Colfax	6-12	>72	17	---	---	---	F3
Fill Over Rion	6-12	>72	>72	45	24-60	36-48	Q1
Hard Labor I	6-12	>72	33	75	6-32	18-20	C1B
Hard Labor II	6-12	>72	48	70	12-48	18-24	P
Madison	2-25	>72	>72	45	24-60	36-48	A
Pacolet	2-25	>72	>72	45	24-60	36-48	A
Rion	6-12	>72	>72	45	24-60	36-48	A
Starr	2-6	>72	>72	---	---	---	F4
Udorthent Fill	10-25	>48	>48	---	---	---	F5

\* Seasonal High Water Table

\*\*Auger refusal was encountered on hard weathered rock at depths ranging from 27 to 58 inches.



**SOIL SUITABILITY LEGEND  
LEVEL 4 SOIL MAPPING  
HAMBRICK CREEK S/D  
LOTS 210, 211, 212, 213, 215, 216, 221, 228  
L.L. 131, 11<sup>TH</sup> DISTRICT  
HENRY COUNTY, GEORGIA**

- A Soils are typically suitable for conventional absorption field with proper design, installation and maintenance.
- C1B Soils are unsuitable for conventional absorption fields due to seasonal perched water table conditions. Soils are generally suitable for shallow trench absorption fields with treatment system producing Class I effluent. The local Environmental Health Specialist must approve non-conventional system design and installation.
- F2 Soils are unsuitable for on-site wastewater disposal due to seasonal high water table.
- F3 Soils are unsuitable for on-site wastewater disposal due to shallow perched water table.
- F4 Soils are unsuitable for on-site wastewater disposal due to flooding and / or storm water drainage patterns.
- F5 Soil consists of poorly sorted fill that is unsuitable for on-site wastewater disposal.
- N6 Soils contain somewhat shallow parent material and partially weathered rock. Soils are generally suitable for conventional absorption field with shallow trench as recommended. Backhoe pits excavated during system installation may reveal absence of hard bedrock that would allow deeper trenches to be installed in this soil.
- P Soils have a deep seasonal perched water table. Absorption trenches installed 24 inches above seasonal high water table should function effectively. Estimated percolation rate is for recommended trench depth. Some fill may need to be mounded over absorption field to divert storm water and provide adequate cover over trenches.
- Q1 Soils contain variable depth of fill over well drained upland soil. Absorption field should be installed so that chambers are entirely in natural soil. Estimated percolation rate is for natural soil underlying fill. Trench depth should be determined in the field after identifying greatest depth of fill within absorption field area.

