

SITE PLAN

LOCATION: Main St, Newberry, SC 29108, USA
SITE CITY: NEWBERRY
PARCEL ID: 397-98

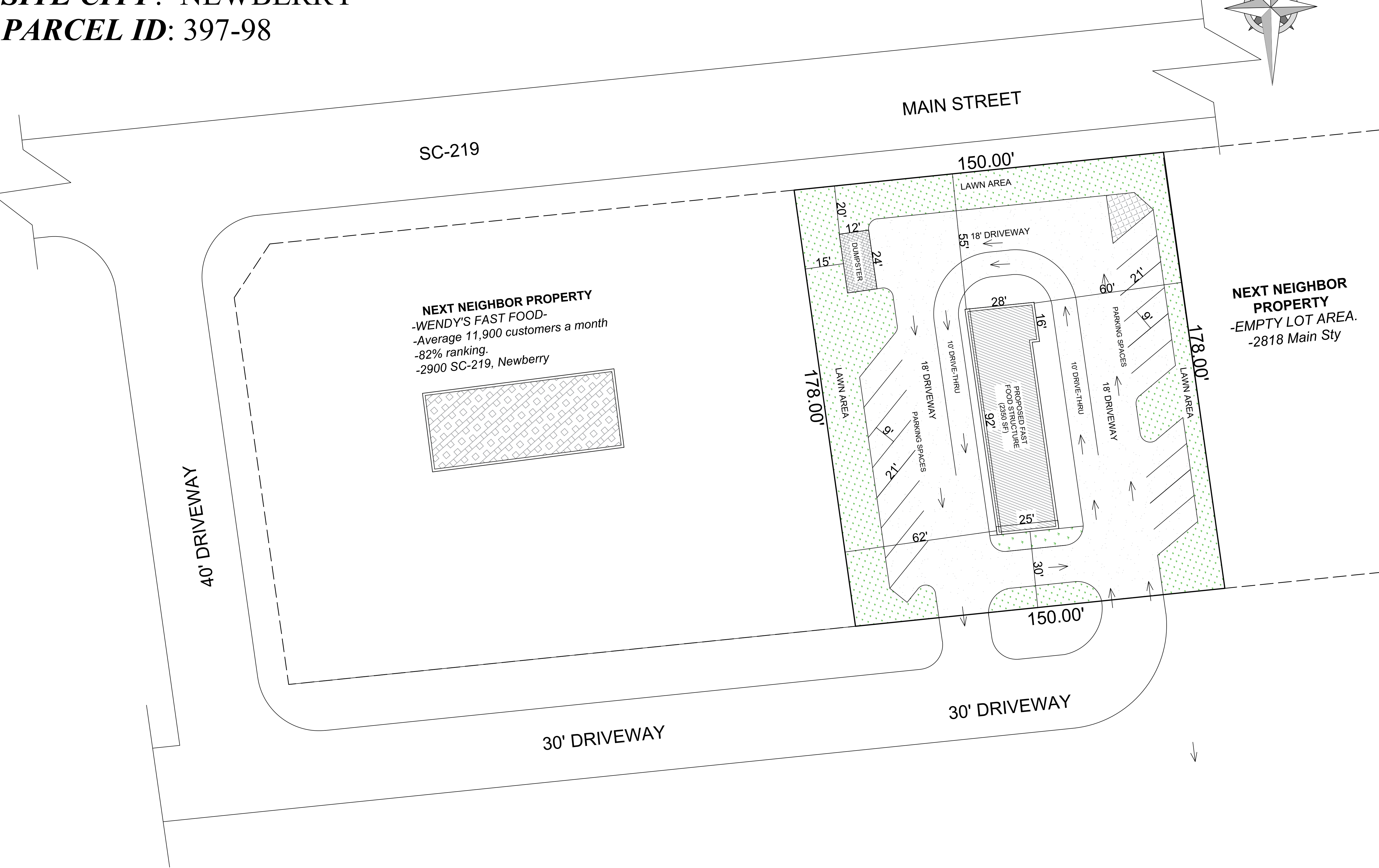

VICINITY MAP

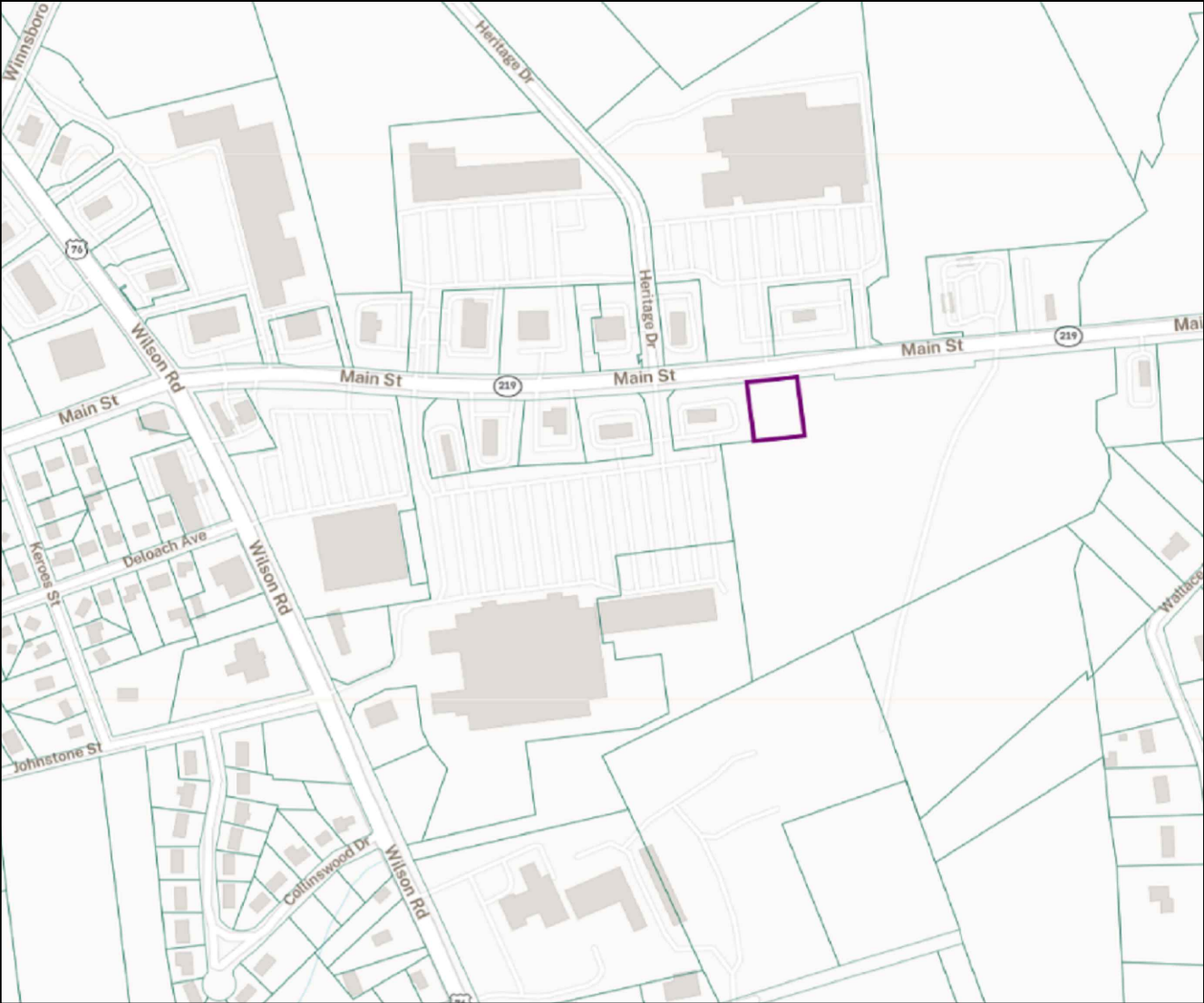

SCOPE OF WORK

-SITE PLAN OF THE PROPERTY UNDER REVIEW
-SHOWING THE PROPOSED COMMERCIAL
DEVELOPMENT.

General Commercial GC(City of Newberry, SC):
The GC district is intended to accomodate a variety of general commercial and non-residential uses engaged primarily in the sale of durable goods, equipment and services. Recreational, cultural, and healthcare facilities, K-12 schools, colleges, government and public safety services, nursing homes, assisted living facilities, day care centers, eating and drinking establishment, and hotels and motels are also allowed.

LOT SIZE

0.61 Acres
=
26,700 SF

SHEET TITLE
SITE PLAN

LOT OWNER:
BZR HWY 219 Trust

DEEN'S CONSULTS

Architects , Planners & Project Managers

ISMAILAOTU@GMAIL.COM

	ARCHITECT	<i>Deen's consult</i>	
	DRAWN	<i>Deen's consult</i>	
	CHECKED BY	<i>Deen's consult</i>	
SCALE:	1":30'	DATE	05-14-2023

SHEET NO.
01