

PLAT OF IRREGULAR DESCRIPTION (Sec. 57-02-39-N.D.C.C.)

# PLAT OF

AUDITOR'S LOTS D & E OF LOT 1 BLOCK 1 NORTHERN  
PLAINS COMMERCE CENTRE ADDITION AND AUDITOR'S LOT A  
OF LOT 2 BLOCK 1 BISMARCK AIRPORT ADDITION

Section 11&12, Township 138 N., Range 80 W.

Present Owner

City of Bismarck

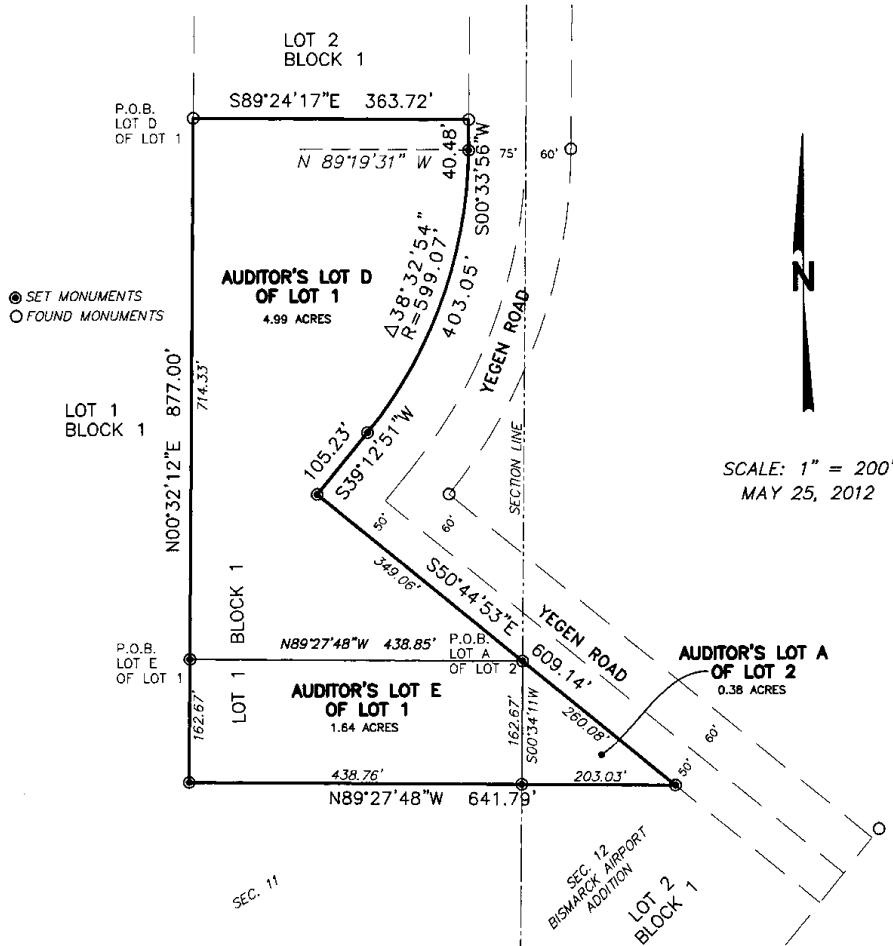

## AUDITOR'S LOT D OF LOT 1

1995.001.001

PART OF LOT 1 BLOCK 1 OF NORTHERN PLAINS COMMERCE CENTRE ADDITION, BURLEIGH COUNTY, NORTH DAKOTA DESCRIBED AS FOLLOWS:

BEGINNING AT THE SOUTHWEST CORNER OF LOT 2 BLOCK 1 OF SAID NORTHERN PLAINS COMMERCE CENTRE; THENCE SOUTH 89 DEGREES 24 MINUTES 17 SECONDS EAST, ALONG THE SOUTH BOUNDARY OF SAID LOT 2 BLOCK 1, A DISTANCE OF 363.72 FEET TO THE EASTERLY BOUNDARY OF SAID LOT 1 BLOCK 1; THENCE SOUTH 00 DEGREES 33 MINUTES 56 SECONDS WEST, ALONG SAID BOUNDARY, A DISTANCE OF 40.48 FEET; THENCE SOUTHWESTERLY AND TO THE RIGHT, ON A NON TANGENT 599.07 FOOT RADIUS CURVE, THE RADIUS OF WHICH BEARS NORTH 89 DEGREES 19 MINUTES 31 SECONDS WEST, CONTINUING ALONG SAID BOUNDARY, AN ARC LENGTH OF 403.05 FEET; THENCE SOUTH 39 DEGREES 12 MINUTES 51 SECONDS WEST, CONTINUING ALONG SAID BOUNDARY, A DISTANCE OF 105.23 FEET; THENCE SOUTH 50 DEGREES 44 MINUTES 53 SECONDS EAST, CONTINUING ALONG SAID BOUNDARY, A DISTANCE OF 349.06 FEET; THENCE NORTH 89 DEGREES 27 MINUTES 48 SECONDS WEST, A DISTANCE OF 438.85 FEET; THENCE NORTH 00 DEGREES 32 MINUTES 12 SECONDS EAST, A DISTANCE OF 714.33 FEET TO THE POINT OF BEGINNING.

THE ABOVE DESCRIBED TRACT CONTAINS 4.99 ACRES, MORE OR LESS.

## AUDITOR'S LOT E OF LOT 1

1995.001.001

PART OF LOT 1 BLOCK 1 OF NORTHERN PLAINS COMMERCE CENTRE ADDITION, BURLEIGH COUNTY, NORTH DAKOTA DESCRIBED AS FOLLOWS:

BEGINNING AT A POINT THAT LIES SOUTH 00 DEGREES 32 MINUTES 12 SECONDS WEST, A DISTANCE OF 714.33 FEET FROM THE SOUTHWEST CORNER OF LOT 2 BLOCK 1 OF SAID NORTHERN PLAINS COMMERCE CENTRE ADDITION; THENCE SOUTH 89 DEGREES 27 MINUTES 48 SECONDS EAST, A DISTANCE OF 438.85 FEET TO THE EASTERLY BOUNDARY OF SAID LOT 1 BLOCK 1 AND THE EAST LINE OF SECTION 11; THENCE SOUTH 00 DEGREES 34 MINUTES 11 SECONDS WEST, ALONG SAID EAST SECTION LINE, A DISTANCE OF 162.67 FEET; THENCE NORTH 89 DEGREES 27 MINUTES 48 SECONDS WEST, A DISTANCE OF 438.76 FEET; THENCE NORTH 00 DEGREES 32 MINUTES 12 SECONDS EAST, A DISTANCE OF 162.67 FEET TO THE POINT OF BEGINNING.

THE ABOVE DESCRIBED TRACT CONTAINS 1.64 ACRES, MORE OR LESS.

## AUDITOR'S LOT A OF LOT 2

1995.001.001

PART OF LOT 2 BLOCK 1 OF BISMARCK AIRPORT ADDITION, BURLEIGH COUNTY, NORTH DAKOTA DESCRIBED AS FOLLOWS:

BEGINNING AT THE MOST NORTHERLY CORNER OF LOT 2 BLOCK 1 OF SAID BISMARCK AIRPORT ADDITION; THENCE SOUTH 00 DEGREES 34 MINUTES 11 SECONDS WEST, ALONG THE WESTERLY BOUNDARY OF SAID LOT 2, A DISTANCE OF 162.67 FEET; THENCE SOUTH 89 DEGREES 27 MINUTES 48 SECONDS EAST, A DISTANCE OF 203.03 FEET TO THE EASTERLY BOUNDARY OF SAID LOT 2; THENCE NORTH 50 DEGREES 44 MINUTES 53 SECONDS WEST, ALONG SAID BOUNDARY, A DISTANCE OF 260.08 FEET TO THE POINT OF BEGINNING.

THE ABOVE DESCRIBED TRACT CONTAINS 0.38 ACRES, MORE OR LESS.

THE UNDERSIGNED, Owners of the within described property, in accordance with the provisions of Sec. 57-02-39, North Dakota Century Code, and upon demand of the County Auditor of Burleigh County, North Dakota, have caused to be made the within and foregoing plat of said land with the lots as herein described, and have caused the same to be placed on record, as provided by law.

Witness our hands and seal, this 26<sup>th</sup> day of November, 2012. 2013

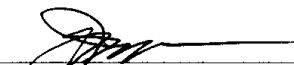
  
John Warford, Mayor

  
Bill Wocken, City Administrator

STATE OF NORTH DAKOTA )

) ss

COUNTY OF BURLEIGH )

On this 26<sup>th</sup> day of November, 2012, before me personally appeared John Warford and William (Bill) Wocken, known to be the same person described in and who executed the within and foregoing instrument and acknowledged that he executed the same.

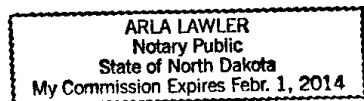

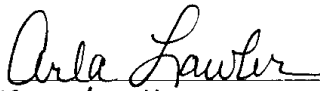
  
Arla Lawler, Notary Public  
Burleigh County, North Dakota

I, Tim Langerud, Professional Land Surveyor, do hereby certify that, at the request of City of Bismarck, made the within and foregoing plat and description of the land as herein described and that the lots, distances, area and locations as indicated on said plat and contained in said description are true and correct.

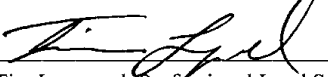
  
Tim Langerud, Professional Land Surveyor

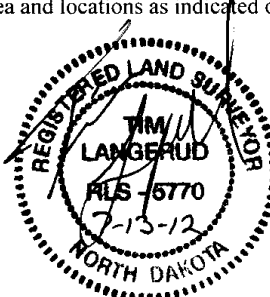



STATE OF NORTH DAKOTA )

) ss

COUNTY OF BURLEIGH )

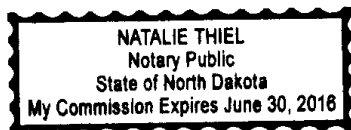
On this 13<sup>th</sup> day of July, 2012, before me personally appeared Tim Langerud, known to be the same person described in and who executed the within and foregoing instrument and acknowledged that he executed the same.



  
June 30, 2016, Notary Public  
Burleigh County, North Dakota

#### CERTIFICATE OF APPROVAL

The within and foregoing Plat is hereby approved this 25<sup>th</sup> day of November, 2012.

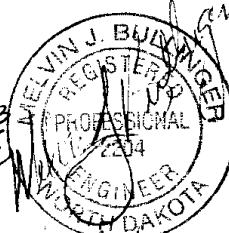

  
City Engineer  
City of Bismarck, Burleigh, ND

TRANSFER accepted this 27 day of

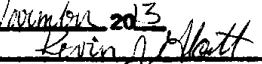
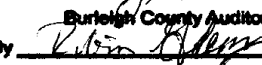
November, 2013  
  
Burleigh County Auditor  
By   
Deputy, Burleigh County Auditor

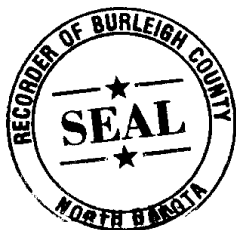

# PLAT OF

AUDITOR'S LOT N OF LOT 1 BLOCK 1 NORTHERN PLAINS  
COMMERCE CENTRE ADDITION

Section 11, Township 138 N, Range 80 W

Present Owner CITY OF BISMARCK

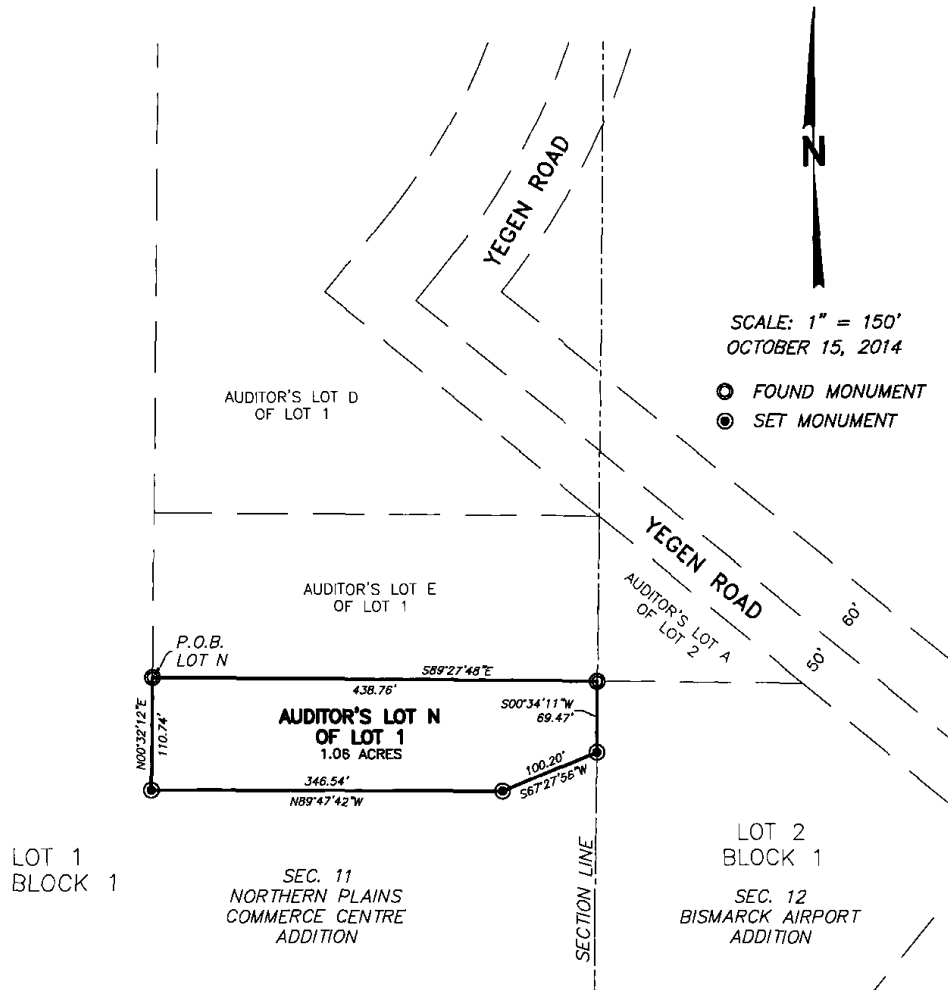

## AUDITOR'S LOT N OF LOT 1

1995-001 001

PART OF LOT 1 BLOCK 1 OF NORTHERN PLAINS COMMERCE CENTRE ADDITION, BURLEIGH COUNTY, NORTH DAKOTA DESCRIBED AS FOLLOWS:

BEGINNING AT THE SOUTHWEST CORNER OF AUDITOR'S LOT E OF LOT 1 BLOCK 1 NORTHERN PLAINS COMMERCE CENTRE ADDITION; THENCE SOUTH 89 DEGREES 27 MINUTES 48 SECONDS EAST, ALONG THE BOUNDARY OF SAID AUDITOR'S LOT E, A DISTANCE OF 438.76 FEET TO THE EAST LINE OF SECTION 11; THENCE SOUTH 00 DEGREES 34 MINUTES 11 SECONDS WEST, ALONG SAID EAST LINE, A DISTANCE OF 69.47 FEET; THENCE SOUTH 87 DEGREES 27 MINUTES 56 SECONDS WEST, A DISTANCE OF 100.20 FEET; THENCE NORTH 89 DEGREES 47 MINUTES 42 SECONDS WEST, A DISTANCE OF 346.54 FEET TO THE SOUTHERLY EXTENSION OF THE WEST LINE OF SAID AUDITOR'S LOT E; THENCE NORTH 00 DEGREES 32 MINUTES 12 SECONDS EAST, ALONG SAID SOUTHERLY EXTENSION, A DISTANCE OF 110.74 FEET TO THE POINT OF BEGINNING.

THE ABOVE DESCRIBED TRACT CONTAINS 1.06 ACRES, MORE OR LESS.

TRANSFER accepted this 28 day of

Oct 2014

Burleigh County Auditor

By Deputy, Burleigh County Auditor



814513

\$13.00  
Page: 1 of 2  
10/28/2014 8:49 AM  
Burleigh County

THE UNDERSIGNED, Owners of the within described property, in accordance with the provisions of Sec. 57-02-39, North Dakota Century Code, and upon demand of the County Auditor of Burleigh County, North Dakota, have caused to be made the within and foregoing plat of said land with the lots as herein described, and have caused the same to be placed on record, as provided by law.

Witness our hands and seal, this 27 day of October, 2014.

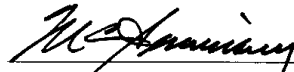
  
Michael C. Seminary, Mayor

  
W.C. Wocken, City Administrator

STATE OF NORTH DAKOTA )  
 ) ss  
COUNTY OF BURLEIGH )

On this 27 day of October, 2014, before me personally appeared  
Michael Seminary W.C. Wocken, known to be the same  
person described in and who executed the within and foregoing instrument and acknowledged that he  
executed the same.

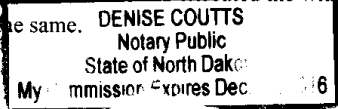

  
Notary Public, Burleigh County, North Dakota

I, Tim Langerud Professional Land Surveyor, do hereby certify that, at the  
request of City of Bismarck, made the within and foregoing plat and description of the land  
as herein described and that the lots, distances, area and locations as indicated on said plat and contained  
in said description are true and correct.

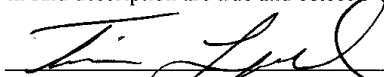
  
Tim Langerud, Professional Land Surveyor

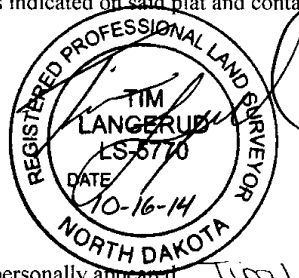

STATE OF NORTH DAKOTA )  
 ) ss  
COUNTY OF BURLEIGH )

On this 10th day of October, 2014, before me personally appeared Tim Langerud  
known to be the same person described in and who executed the within and foregoing instrument and  
acknowledged that he executed the same.



  
June 30, 2016, Notary Public  
Burleigh County, North Dakota

#### CERTIFICATE OF APPROVAL

The within and foregoing Plat is hereby approved this 27th day of October, 2014.

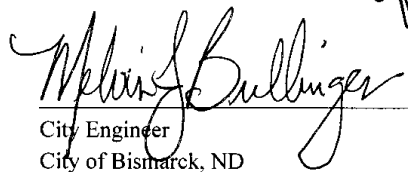
  
City Engineer  
City of Bismarck, ND

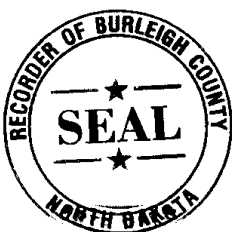
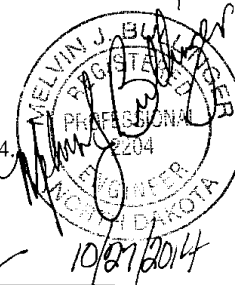

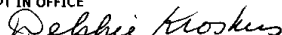

**814513**  
\$13.00  
Page: 2 of 2  
10/28/2014 8:49 AM  
Burleigh County

# PLAT OF

AUDITOR'S LOT B OF LOT 2 BLOCK 1  
BISMARCK AIRPORT ADDITION

Section 12, Township 138 N, Range 80 W

Present Owner CITY OF BISMARCK

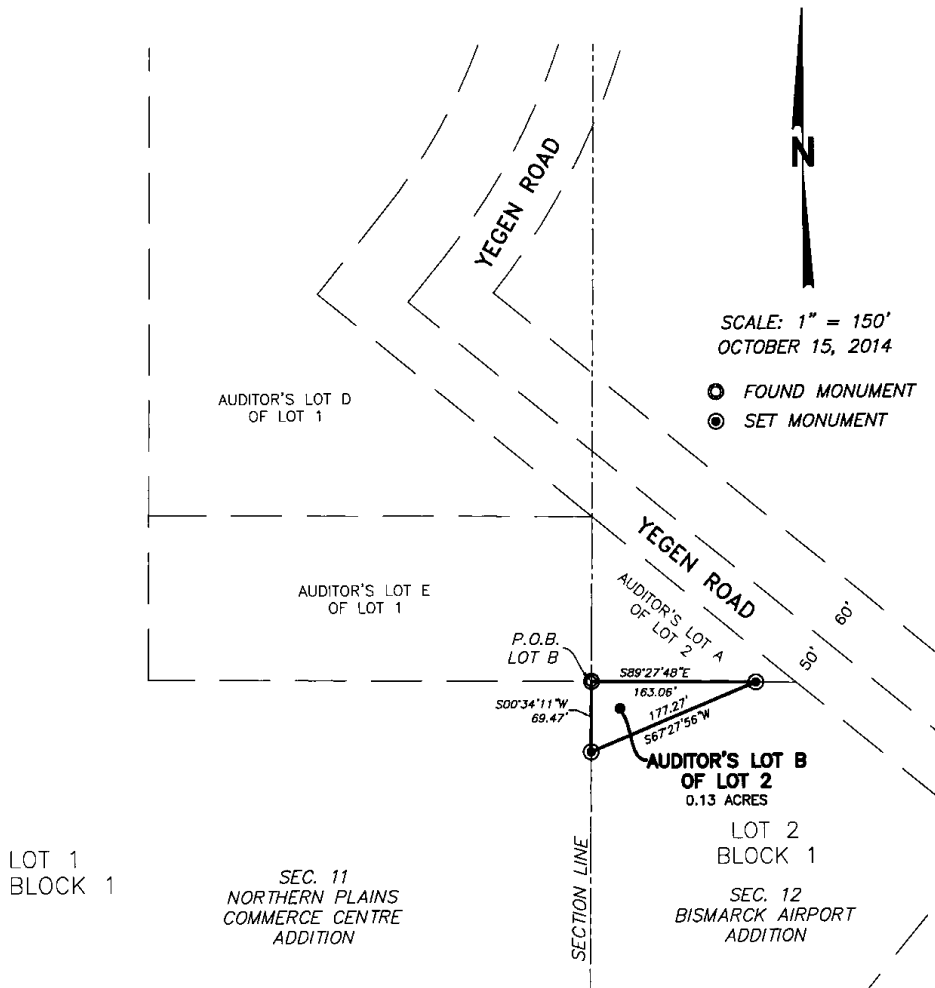

## AUDITOR'S LOT B OF LOT 2

PART OF LOT 2 BLOCK 1 OF BISMARCK AIRPORT ADDITION, BURLEIGH COUNTY, NORTH DAKOTA DESCRIBED AS FOLLOWS:

BEGINNING AT THE SOUTHWEST CORNER OF AUDITOR'S LOT A OF LOT 2 BLOCK 1 BISMARCK AIRPORT ADDITION; THENCE SOUTH 89 DEGREES 27 MINUTES 48 SECONDS EAST, ALONG THE BOUNDARY OF SAID AUDITOR'S LOT A, A DISTANCE OF 163.06 FEET; THENCE SOUTH 67 DEGREES 27 MINUTES 56 SECONDS WEST, A DISTANCE OF 177.27 FEET TO THE WEST LINE OF SECTION 12; THENCE NORTH 00 DEGREES 34 MINUTES 11 SECONDS EAST, ALONG SAID WEST LINE, A DISTANCE OF 69.47 FEET TO THE POINT OF BEGINNING.

THE ABOVE DESCRIBED TRACT CONTAINS 0.13 ACRES, MORE OR LESS.

TRANSFER accepted this 28 day of Oct, 2014  
[Signature]  
 Burleigh County Auditor  
 By [Signature]  
 Deputy, Burleigh County Auditor

THE UNDERSIGNED, Owners of the within described property, in accordance with the provisions of Sec. 57-02-39, North Dakota Century Code, and upon demand of the County Auditor of Burleigh County, North Dakota, have caused to be made the within and foregoing plat of said land with the lots as herein described, and have caused the same to be placed on record, as provided by law.

Witness our hands and seal, this 27 day of October, 2014.

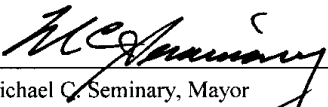
  
Michael C. Seminary, Mayor

  
W.C. Wocken, City Administrator

STATE OF NORTH DAKOTA )  
 ) ss  
COUNTY OF BURLEIGH )

On this 27 day of October, 2014, before me personally appeared  
Michael Seminary W.C. Wocken, known to be the same  
person described in and who executed the within and foregoing instrument and acknowledged that he  
executed the same.

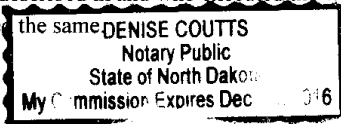

  
Notary Public, Burleigh County, North Dakota

I, Tim Langerud Professional Land Surveyor, do hereby certify that, at the  
request of City of Bismarck, made the within and foregoing plat and description of the land  
as herein described and that the lots, distances, area and locations as indicated on said plat and contained  
in said description are true and correct.

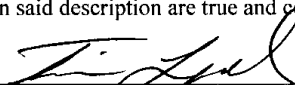
  
Tim Langerud, Professional Land Surveyor

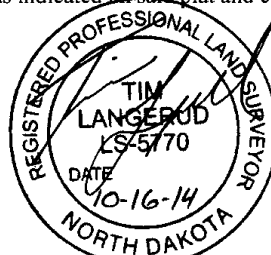

STATE OF NORTH DAKOTA )  
 ) ss  
COUNTY OF BURLEIGH )

On this 10th day of October, 2014, before me personally appeared Tim Langerud  
known to be the same person described in and who executed the within and foregoing instrument and  
acknowledged that he executed the same.

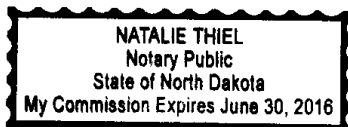

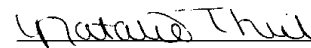
  
Natalie Thiel, Notary Public  
Burleigh County, North Dakota

#### CERTIFICATE OF APPROVAL

The within and foregoing Plat is hereby approved this 27th day of October, 2014.

  
City Engineer  
City of Bismarck, ND

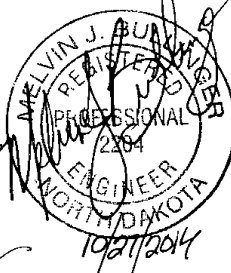

814514

\$13.00  
Page: 2 of 2  
10/28/2014 8:49 AM  
Burleigh County





*Debbie Krokus*

862045

520 00  
Page 1 of 2  
9/8/2017 8:03 AM  
Burleigh County



PLAT OF IRREGULAR DESCRIPTION (Sec 57-02-39-NDCC)

## PLAT OF

AUDITOR'S LOT T OF LOT 1 BLOCK 1  
NORTHERN PLAINS COMMERCE CENTRE ADDITION Section 11, Township 138 N, Range 80 W

Present Owner CITY OF BISMARCK

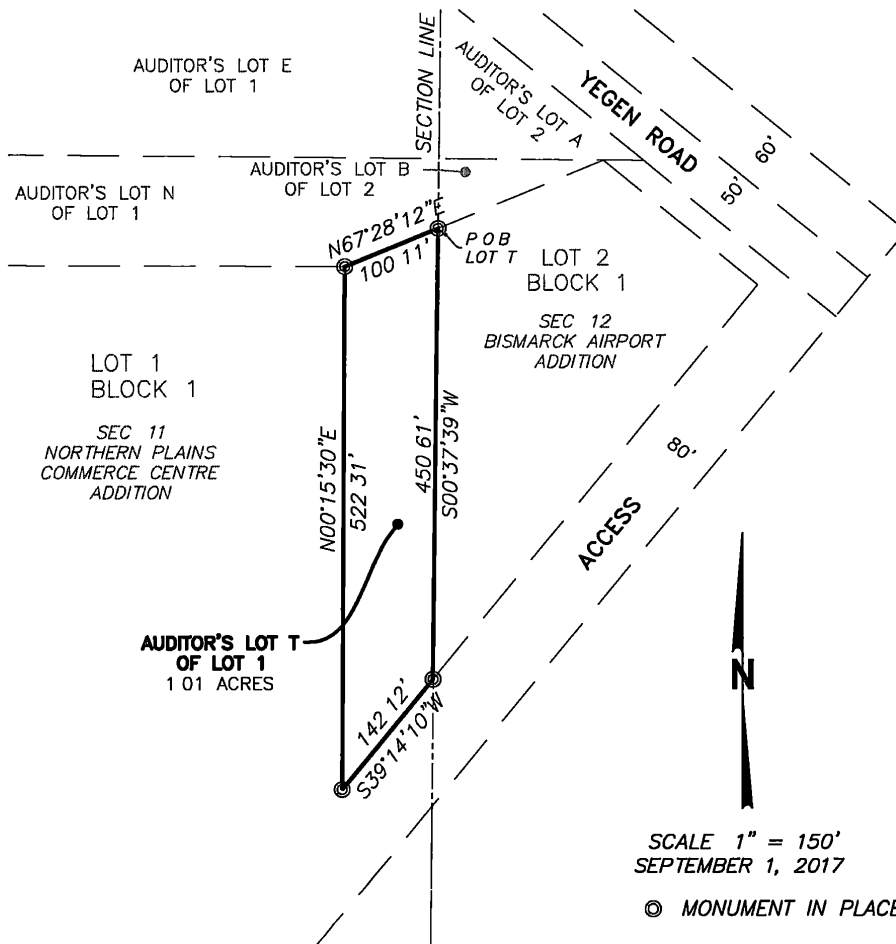

SCALE 1" = 150'  
SEPTEMBER 1, 2017

© MONUMENT IN PLACE

### AUDITOR'S LOT T OF LOT 1

PART OF LOT 1 BLOCK 1 OF NORTHERN PLAINS COMMERCE CENTRE ADDITION,  
BURLEIGH COUNTY, NORTH DAKOTA DESCRIBED AS FOLLOWS

BEGINNING AT THE SOUTHEASTERLY CORNER OF AUDITOR'S LOT N OF LOT 1  
BLOCK 1 NORTHERN PLAINS COMMERCE CENTRE ADDITION, THENCE SOUTH 00 DEGREES  
37 MINUTES 39 SECONDS WEST, ALONG THE EAST LINE OF SECTION 11, A DISTANCE OF  
450 61 FEET, THENCE SOUTH 39 DEGREES 14 MINUTES 10 SECONDS WEST, A  
DISTANCE OF 142 12 FEET, THENCE NORTH 00 DEGREES 15 MINUTES 30 SECONDS  
EAST, A DISTANCE OF 522 31 FEET TO THE SOUTH LINE OF SAID AUDITOR'S LOT N,  
THENCE NORTH 67 DEGREES 28 MINUTES 12 SECONDS EAST, ALONG SAID SOUTH LINE,  
A DISTANCE OF 100 11 FEET TO THE POINT OF BEGINNING

THE ABOVE DESCRIBED TRACT CONTAINS 1 01 ACRES, MORE OR LESS

THE UNDERSIGNED, Owners of the within described property, in accordance with the provisions of Sec 57-02-39, North Dakota Century Code, and upon demand of the County Auditor of Burleigh County, North Dakota, have caused to be made the within and foregoing plat of said land with the lots herein described, and have caused the same to be placed on record, as provided by law

Witness our hand and seal, this 7<sup>th</sup> day of September, 2017

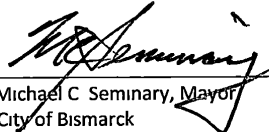
  
Michael C Seminary, Mayor  
City of Bismarck  
221 N 5<sup>th</sup> St  
Bismarck, ND 58503

STATE OF NORTH DAKOTA )  
 )SS  
COUNTY OF BURLEIGH )

On this 7<sup>th</sup> day of September, 2017, before me personally appeared Michael C Seminary, known to be the same person described in and who executed the within and foregoing instrument and acknowledged that he executed the same

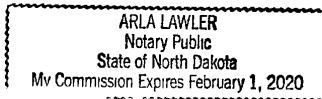

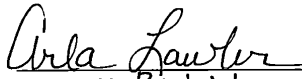
  
Arla Lawler  
Notary Public, Burleigh County, North Dakota

I, Terry Baltzer, Professional Land Surveyor, do hereby certify that, at the request of The City of Bismarck, made the within and foregoing plat and description of the land as herein described and that the lots, distances, area, and locations as indicated on said plat and contained in said description are true and correct

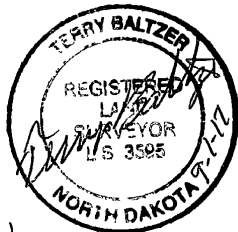

  
Terry Baltzer, Professional Land Surveyor  
ND Registration No 3595

STATE OF NORTH DAKOTA )  
 )SS  
COUNTY OF BURLEIGH )

On this 15<sup>th</sup> day of September, 2017, before me personally appeared Terry Baltzer, known to be the same person described in and who executed the within and foregoing instrument and acknowledged that he executed the same

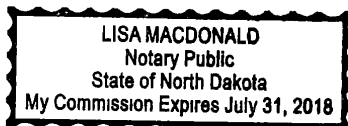

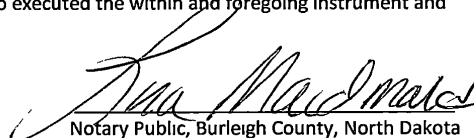
  
Lisa Macdonald  
Notary Public, Burleigh County, North Dakota

CERTIFICATE OF APPROVAL

The within and foregoing Plat is hereby approved this 7 day of September, 2017

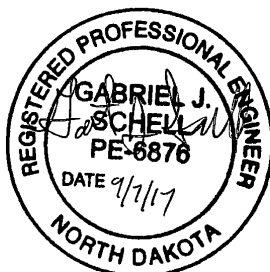

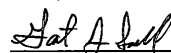
  
Gabriel J. Schell  
City Engineer  
City of Bismarck, ND

Taxes and special assessments paid, all liens created under section 57-02-08 3 satisfied, if any, and TRANSFER accepted this 7<sup>th</sup> day of September, 2017  
John A. Schell  
Burleigh County Auditor  
By E. Buchholz  
Deputy, Burleigh County Auditor





PLAT OF IRREGULAR DESCRIPTION (Sec 57-02-39-NDCC)

## PLAT OF

AUDITOR'S LOT C OF LOT 2 BLOCK 1  
BISMARCK AIRPORT ADDITION

Section 12, Township 138 N, Range 80 W

Present Owner CITY OF BISMARCK

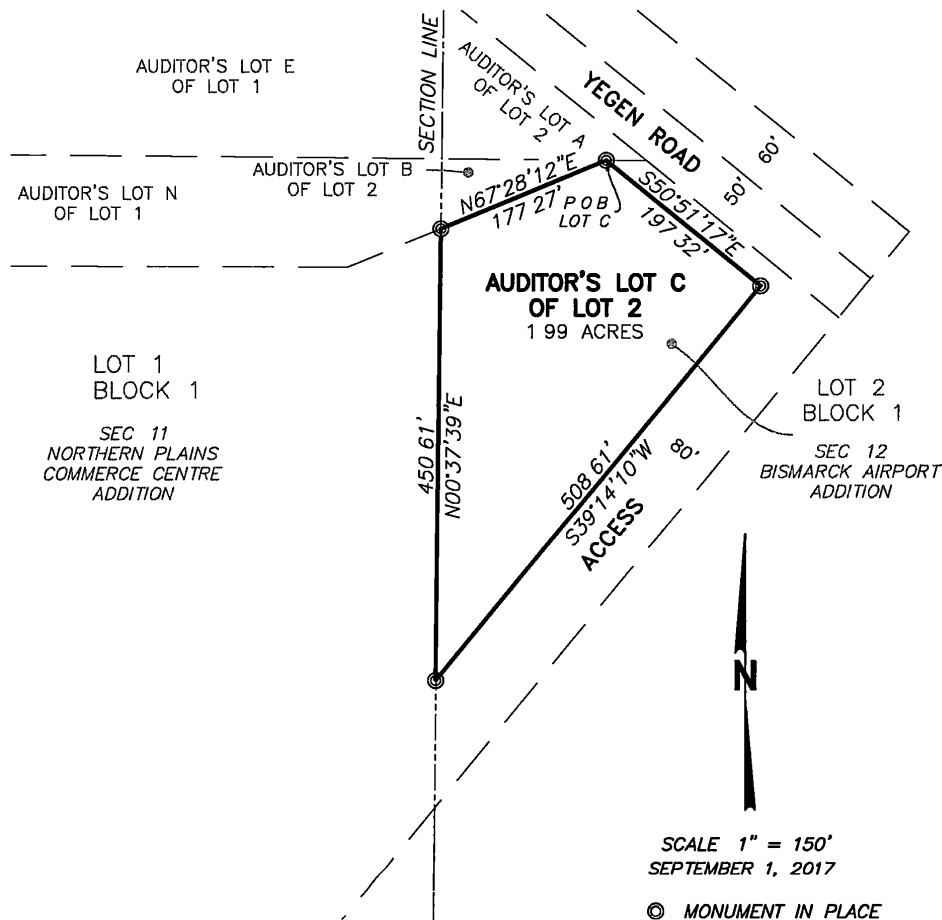

### AUDITOR'S LOT C OF LOT 2

PART OF LOT 2 BLOCK 1 OF BISMARCK AIRPORT ADDITION, BURLEIGH COUNTY, NORTH DAKOTA DESCRIBED AS FOLLOWS

BEGINNING AT THE EASTMOST CORNER OF AUDITOR'S LOT B OF LOT 2 BLOCK 1 BISMARCK AIRPORT ADDITION, THENCE SOUTH 50 DEGREES 51 MINUTES 17 SECONDS EAST, PARALLEL WITH YEGEN ROAD, A DISTANCE OF 197.32 FEET, THENCE SOUTH 39 DEGREES 14 MINUTES 10 SECONDS WEST, A DISTANCE OF 508.61 FEET TO THE WEST LINE OF SECTION 12, THENCE NORTH 00 DEGREES 37 MINUTES 39 SECONDS EAST, ALONG SAID WEST LINE, A DISTANCE OF 450.61 FEET TO THE SOUTH LINE OF AUDITOR'S LOT B OF LOT 2 BLOCK 1 BISMARCK AIRPORT ADDITION, THENCE NORTH 67 DEGREES 28 MINUTES 12 SECONDS EAST, ALONG SAID SOUTH LINE, A DISTANCE OF 177.27 FEET TO THE POINT OF BEGINNING

THE ABOVE DESCRIBED TRACT CONTAINS 1.99 ACRES, MORE OR LESS

THE UNDERSIGNED, Owners of the within described property, in accordance with the provisions of Sec 57-02-39, North Dakota Century Code, and upon demand of the County Auditor of Burleigh County, North Dakota, have caused to be made the within and foregoing plat of said land with the lots herein described, and have caused the same to be placed on record, as provided by law

Witness our hand and seal, this 7<sup>th</sup> day of September, 2017

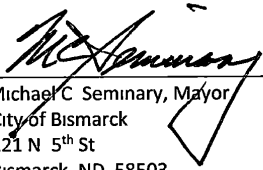
  
Michael C. Seminary, Mayor  
City of Bismarck  
221 N 5<sup>th</sup> St  
Bismarck, ND 58503

STATE OF NORTH DAKOTA )  
 )SS  
COUNTY OF BURLEIGH )

On this 7<sup>th</sup> day of September, 2017, before me personally appeared Michael C. Seminary, known to be the same person described in and who executed the within and foregoing instrument and acknowledged that he executed the same

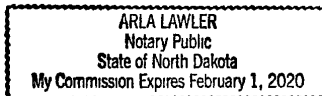

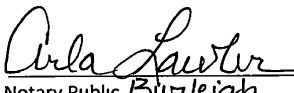
  
Arla Lawler  
Notary Public, Burleigh County, North Dakota

I, Terry Baltzer, Professional Land Surveyor, do hereby certify that, at the request of The City of Bismarck, made the within and foregoing plat and description of the land as herein described and that the lots, distances, area, and locations as indicated on said plat and contained in said description are true and correct



  
Terry Baltzer, Professional Land Surveyor  
ND Registration No. 3595

STATE OF NORTH DAKOTA )  
 )SS  
COUNTY OF BURLEIGH )

On this 1<sup>st</sup> day of September, 2017, before me personally appeared Terry Baltzer, known to be the same person described in and who executed the within and foregoing instrument and acknowledged that he executed the same

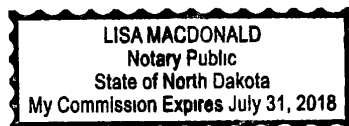

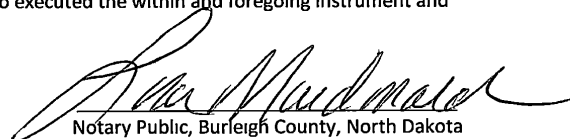
  
Notary Public, Burleigh County, North Dakota

# CERTIFICATE OF APPROVAL

The within and foregoing Plat is hereby approved this 7 day of September, 2017

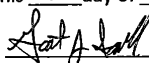

  
Gabriel J. Schell  
City Engineer  
City of Bismarck, ND

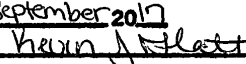
TRANSFER accepted this 7<sup>th</sup> day of September, 2017  
  
Kevin J. Platt  
Burleigh County Auditor  
By E. Buchhorn  
Deputy, Burleigh County Auditor