

SEASONS MARKET SHOPPING CENTER 757 - 783 RADIO DR, WOODBURY, MN 55125



OFFERING SUMMARY

Available SF: 1,000 - 2,040 SF

Lease Rate: \$19.00 SF/yr (NNN)

2018 Tax & CAM: \$12.13 SF/yr

Parking Ratio: 6.34 / 1,000 SF

Year Built: 1988

Building Size: 29,695 SF

Cross Streets: Tamarack Rd & Radio Dr

PROPERTY OVERVIEW

Season's Market is located moments from the retail hub where many national retailers have serviced the communities of Woodbury & Oakdale. Strong population counts and substantial household incomes have attracted national retailers including, Old Navy, Cub Foods, Office Max, Babies R Us, CVS, Dick's Sporting Goods and a host of restaurants.

Surrounding Season's Market are beautiful single and multi-family dwellings, and is connected to more than 100 miles of trails and lovely parks.

PROPERTY HIGHLIGHTS

- 29,695 Total GLA
- Excellent Location on Radio Drive & Tamarack Rd
- 6.34 Parking Stalls per 1,000 SF
- Anchor & Co-Tenants: Holiday Store & Car Wash, Nothing Bundt Cake, East Side LaCrosse, Bel Aire Cleaners, Sweet Pea Floral, Salon Ultimo, Dominos Pizza, The Gaming Goat, Brain Balance, Travel by Nelson, Tom's Tailor, Max Muscle, 9Round, Johnson Jewelers, Duc's Asian Restaurant and Sencha Tea Bar

BARRY BIRNBERG

952.820.1673

barry.birnberg@northcocommercial.com

The information above has been obtained from services we believe to be reliable, however, we accept no responsibility for its correctness.

SEASONS MARKET SHOPPING CENTER 757 - 783 RADIO DR, WOODBURY, MN 55125



BARRY BIRNBERG

952.820.1673

barry.birnberg@northcocommercial.com

The information above has been obtained from services we believe to be reliable, however, we accept no responsibility for its correctness.

SEASONS MARKET SHOPPING CENTER 757 - 783 RADIO DR, WOODBURY, MN 55125



BARRY BIRNBERG

952.820.1673

barry.birnberg@northcocommercial.com

The information above has been obtained from services we believe to be reliable, however, we accept no responsibility for its correctness.

SEASONS MARKET SHOPPING CENTER 757 - 783 RADIO DR, WOODBURY, MN 55125

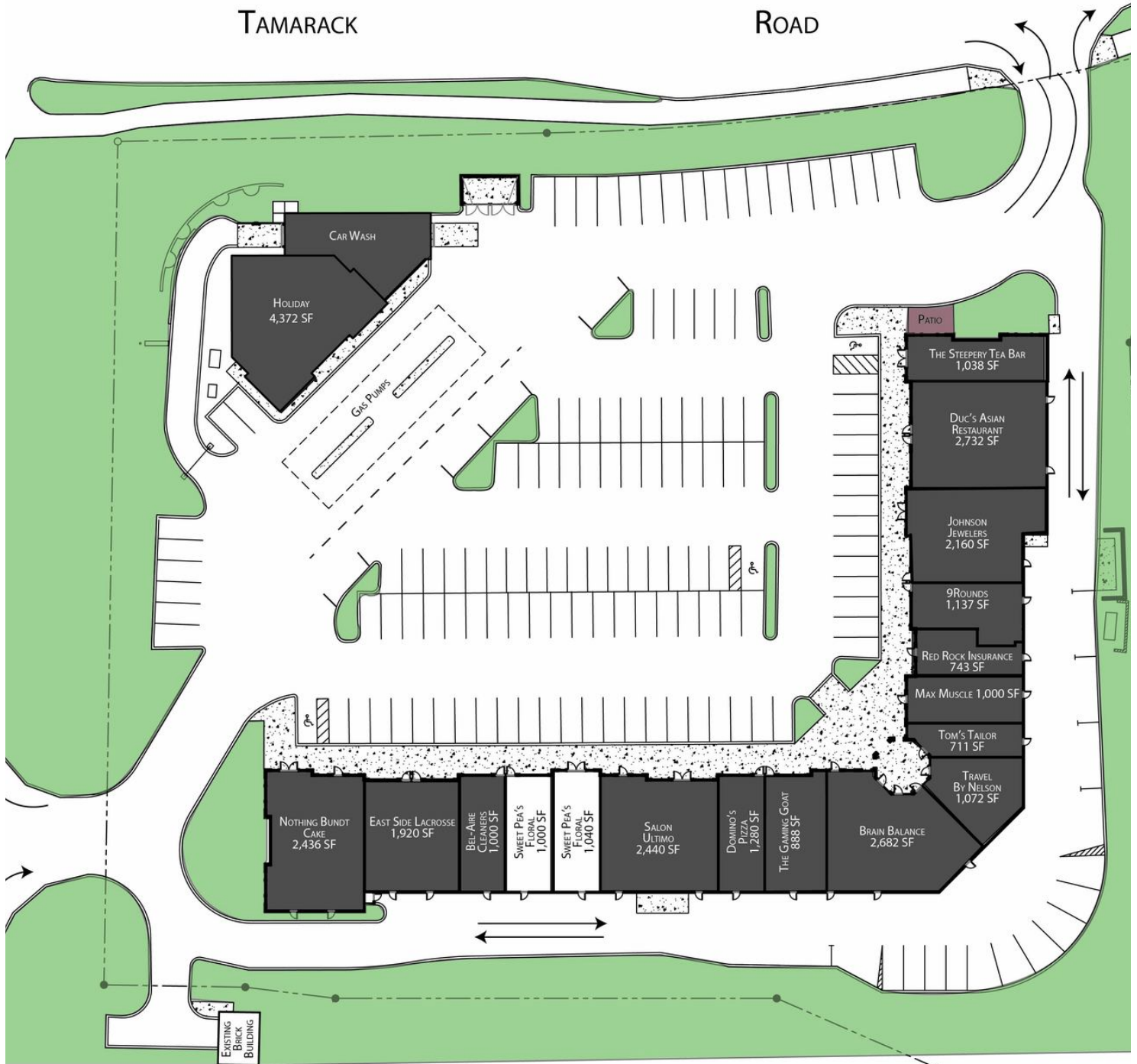

BARRY BIRNBERG

952.820.1673

barry.birnberg@northcocommercial.com

The information above has been obtained from services we believe to be reliable, however, we accept no responsibility for its correctness.

SEASONS MARKET SHOPPING CENTER 757 - 783 RADIO DR, WOODBURY, MN 55125

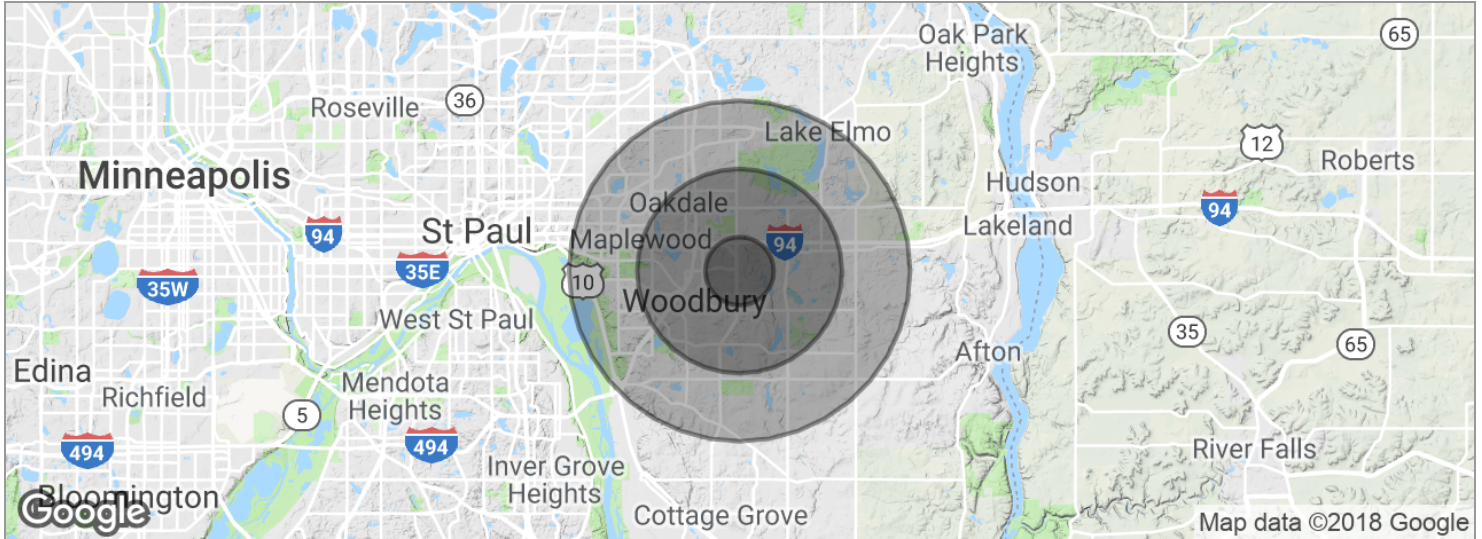

POPULATION	1 MILE	3 MILES	5 MILES
Total population	6,966	57,764	125,402
Median age	36.0	36.6	36.2
Median age (Male)	35.4	35.4	34.9
Median age (Female)	36.3	37.4	37.5
HOUSEHOLDS & INCOME	1 MILE	3 MILES	5 MILES
Total households	2,606	21,365	47,341
# of persons per HH	2.7	2.7	2.6
Average HH income	\$113,255	\$107,294	\$100,013
Average house value	\$307,195	\$287,070	\$290,790

** Demographic data derived from 2010 US Census*

BARRY BIRNBERG

952.820.1673

barry.birnberg@northcocommercial.com

The information above has been obtained from services we believe to be reliable, however, we accept no responsibility for its correctness.

SEASONS MARKET SHOPPING CENTER
757 - 783 RADIO DR, WOODBURY, MN 55125

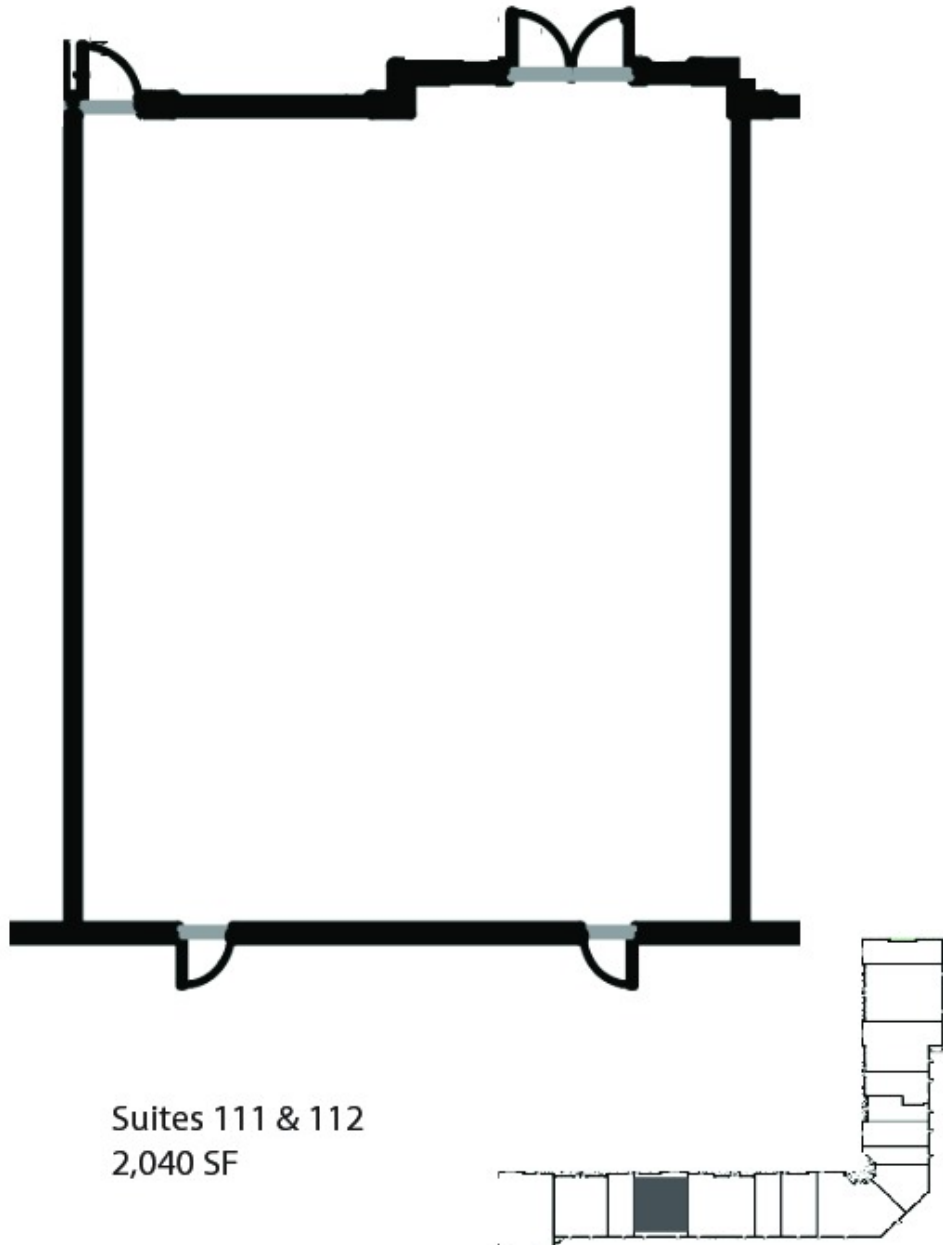

Suites 111 & 112
2,040 SF

BARRY BIRNBERG

952.820.1673

barry.birnberg@northcocommercial.com

SUITES 111 & 112 - 2,040 SF

The information above has been obtained from services we believe to be reliable, however, we accept no responsibility for its correctness.

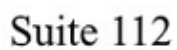

barry.birnberg@northcocommercial.com

The information above has been obtained from services we believe to be reliable, however, we accept no responsibility for its correctness.