

FOR SUBLEASE | INDUSTRIAL

WAREHOUSE FOR SUBLEASE

245 Belmont Drive | Somerset, NJ 08873



PROPERTY SUMMARY

Available SF:	± 32,573 SF
Lease Rate:	\$6.95 SF/yr (NNN)
Lot Size:	± 7.6 Acres
Building Size:	± 99,636 SF
Year Built:	1978
Zoning:	M1
Cross Streets:	Schoolhouse Road

PROPERTY OVERVIEW

32,573 SF Warehouse Sublease Available
Approximately 3,500 SF. +/- office space with kitchen and conference room.

LOCATION OVERVIEW

Located on Belmont Drive, with easy access to I-287, Highway 22, 28 and 206, and the New Jersey Turnpike.

PROPERTY HIGHLIGHTS

- NNN Charges are approximately +/- \$2.20 PSF
- Utilities +/- \$1.07
- Term expires May 31, 2022
- 2 dock doors
- 1 shared drive-in door
- 24' clear ceiling height
- Wet sprinklered
- Racking in place
- Space is demised
- Warehouse bathrooms available
- 40 car parking

FOR MORE INFORMATION, PLEASE CONTACT:

William Sitar Jr. | P: 732.623.2155 | C: 973.202.9119 | bsitarlaw@sitarcompany.com
John Cranley | P: 732.623.2153 | C: 908.370.9808 | cranley@sitarcompany.com

1481 Oak Tree Road
Iselin, NJ 08830
T: 732.283.9000 | F: 732.283.3103
www.sitarcompany.com



Disclaimer: ALL INFORMATION FURNISHED REGARDING PROPERTY FOR SALE, RENTAL OR FINANCING IS FROM SOURCES DEEMED RELIABLE, BUT NO WARRANTY OR REPRESENTATION IS MADE AS TO THE ACCURACY THEREOF AND SAME IS SUBMITTED SUBJECT TO ERRORS, OMISSIONS, CHANGES OF PRICE, RENTAL OR OTHER CONDITIONS, PRIOR SALE, LEASE OR FINANCING OR WITHDRAWAL WITHOUT NOTICE.

WAREHOUSE FOR SUBLEASE

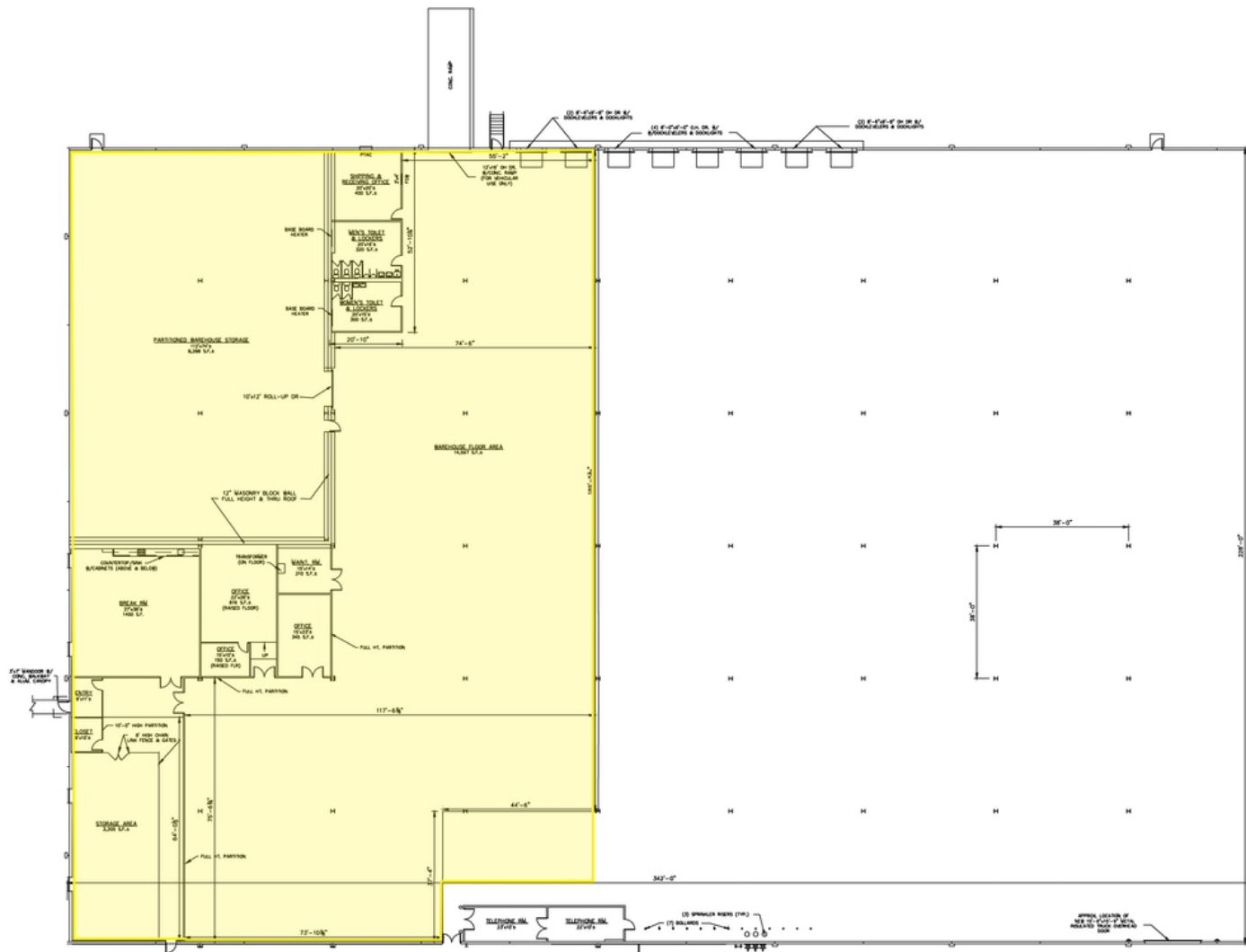

Disclaimer: ALL INFORMATION FURNISHED REGARDING PROPERTY FOR SALE, RENTAL OR FINANCING IS FROM SOURCES DEEMED RELIABLE, BUT NO WARRANTY OR REPRESENTATION IS MADE AS TO THE ACCURACY THEREOF AND SAME IS SUBMITTED SUBJECT TO ERRORS, OMISSIONS, CHANGES OF PRICE, RENTAL OR OTHER CONDITIONS, PRIOR SALE, LEASE OR FINANCING OR WITHDRAWAL WITHOUT NOTICE.

FOR SUBLEASE | INDUSTRIAL

WAREHOUSE FOR SUBLEASE

245 Belmont Drive | Somerset, NJ 08873

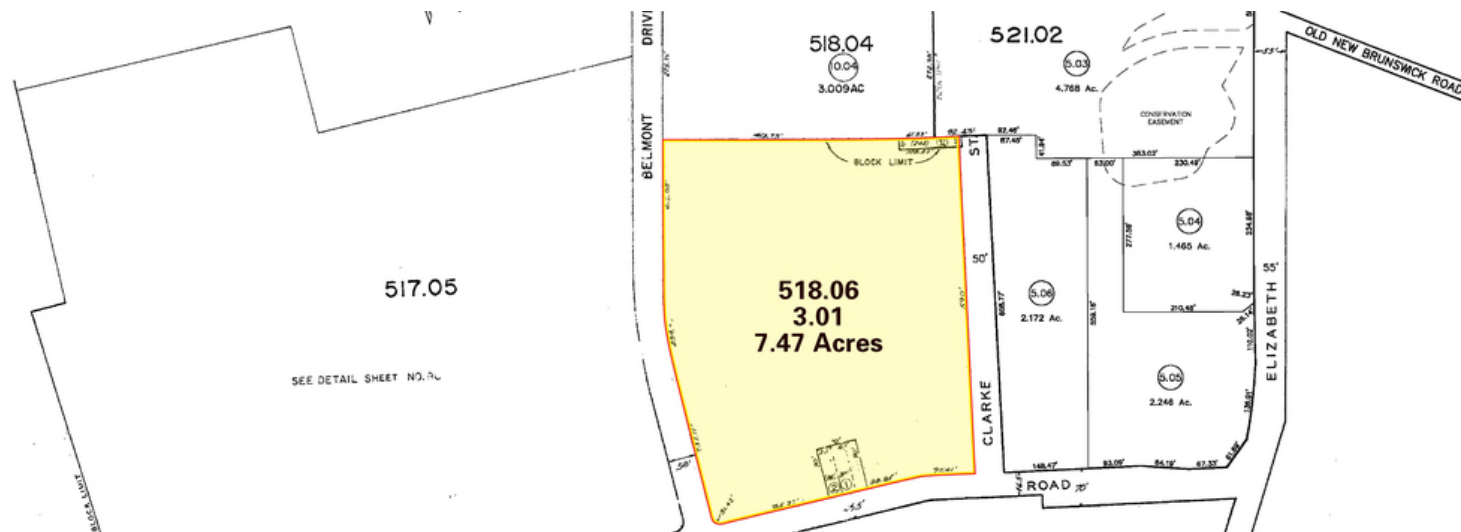

FOR MORE INFORMATION, PLEASE CONTACT:

William Sitar Jr. | P: 732.623.2155 | C: 973.202.9119 | bsitarlaw@sitarcompany.com
John Cranley | P: 732.623.2153 | C: 908.370.9808 | cranley@sitarcompany.com

1481 Oak Tree Road
Iselin, NJ 08830
T: 732.283.9000 | F: 732.283.3103
www.sitarcompany.com



Disclaimer: ALL INFORMATION FURNISHED REGARDING PROPERTY FOR SALE, RENTAL OR FINANCING IS FROM SOURCES DEEMED RELIABLE, BUT NO WARRANTY OR REPRESENTATION IS MADE AS TO THE ACCURACY THEREOF AND SAME IS SUBMITTED SUBJECT TO ERRORS, OMISSIONS, CHANGES OF PRICE, RENTAL OR OTHER CONDITIONS, PRIOR SALE, LEASE OR FINANCING OR WITHDRAWAL WITHOUT NOTICE.

FOR LEASE | INDUSTRIAL

WAREHOUSE FOR SUBLEASE

245 Belmont Drive | Somerset, NJ 08873



FOR MORE INFORMATION, PLEASE CONTACT:

William Sitar Jr. | P: 732.623.2155 | C: 973.202.9119 | bsitarlaw@sitarcompany.com
John Cranley | P: 732.623.2153 | C: 908.370.9808 | cranley@sitarcompany.com

1481 Oak Tree Road
Iselin, NJ 08830
T: 732.283.9000 | F: 732.283.3103
www.sitarcompany.com



Disclaimer: ALL INFORMATION FURNISHED REGARDING PROPERTY FOR SALE, RENTAL OR FINANCING IS FROM SOURCES DEEMED RELIABLE, BUT NO WARRANTY OR REPRESENTATION IS MADE AS TO THE ACCURACY THEREOF AND SAME IS SUBMITTED SUBJECT TO ERRORS, OMISSIONS, CHANGES OF PRICE, RENTAL OR OTHER CONDITIONS, PRIOR SALE, LEASE OR FINANCING OR WITHDRAWAL WITHOUT NOTICE.

FOR LEASE | INDUSTRIAL

WAREHOUSE FOR SUBLEASE

245 Belmont Drive | Somerset, NJ 08873



FOR MORE INFORMATION, PLEASE CONTACT:

William Sitar Jr. | P: 732.623.2155 | C: 973.202.9119 | bsitarlaw@sitarcompany.com
John Cranley | P: 732.623.2153 | C: 908.370.9808 | cranley@sitarcompany.com

1481 Oak Tree Road
Iselin, NJ 08830
T: 732.283.9000 | F: 732.283.3103
www.sitarcompany.com



Disclaimer: ALL INFORMATION FURNISHED REGARDING PROPERTY FOR SALE, RENTAL OR FINANCING IS FROM SOURCES DEEMED RELIABLE, BUT NO WARRANTY OR REPRESENTATION IS MADE AS TO THE ACCURACY THEREOF AND SAME IS SUBMITTED SUBJECT TO ERRORS, OMISSIONS, CHANGES OF PRICE, RENTAL OR OTHER CONDITIONS, PRIOR SALE, LEASE OR FINANCING OR WITHDRAWAL WITHOUT NOTICE.

FOR SUBLEASE | INDUSTRIAL

WAREHOUSE FOR SUBLEASE

245 Belmont Drive | Somerset, NJ 08873

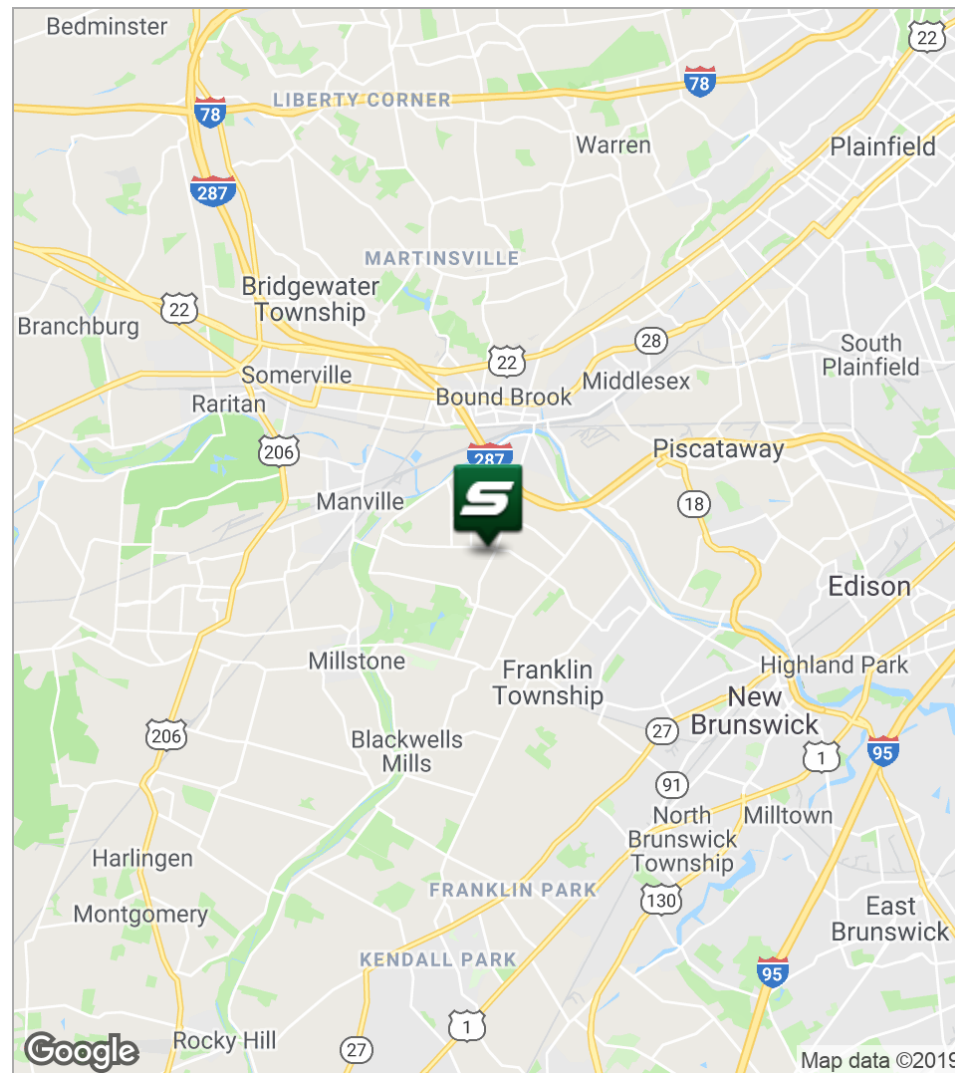
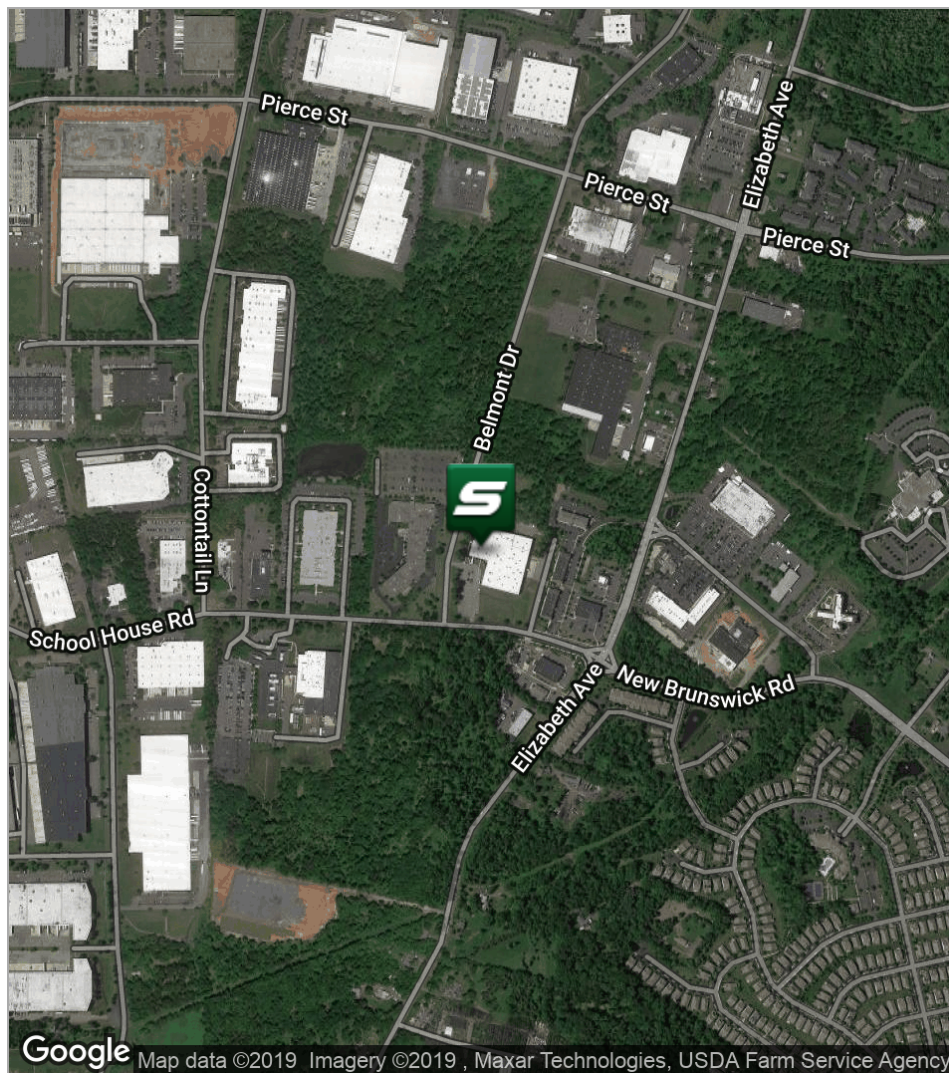

FOR MORE INFORMATION, PLEASE CONTACT:

William Sitar Jr. | P: 732.623.2155 | C: 973.202.9119 | bsitarlaw@sitarcompany.com
John Cranley | P: 732.623.2153 | C: 908.370.9808 | cranley@sitarcompany.com

1481 Oak Tree Road
Iselin, NJ 08830
T: 732.283.9000 | F: 732.283.3103
www.sitarcompany.com



Disclaimer: ALL INFORMATION FURNISHED REGARDING PROPERTY FOR SALE, RENTAL OR FINANCING IS FROM SOURCES DEEMED RELIABLE, BUT NO WARRANTY OR REPRESENTATION IS MADE AS TO THE ACCURACY THEREOF AND SAME IS SUBMITTED SUBJECT TO ERRORS, OMISSIONS, CHANGES OF PRICE, RENTAL OR OTHER CONDITIONS, PRIOR SALE, LEASE OR FINANCING OR WITHDRAWAL WITHOUT NOTICE.

FOR SUBLEASE | INDUSTRIAL

WAREHOUSE FOR SUBLEASE

245 Belmont Drive | Somerset, NJ 08873

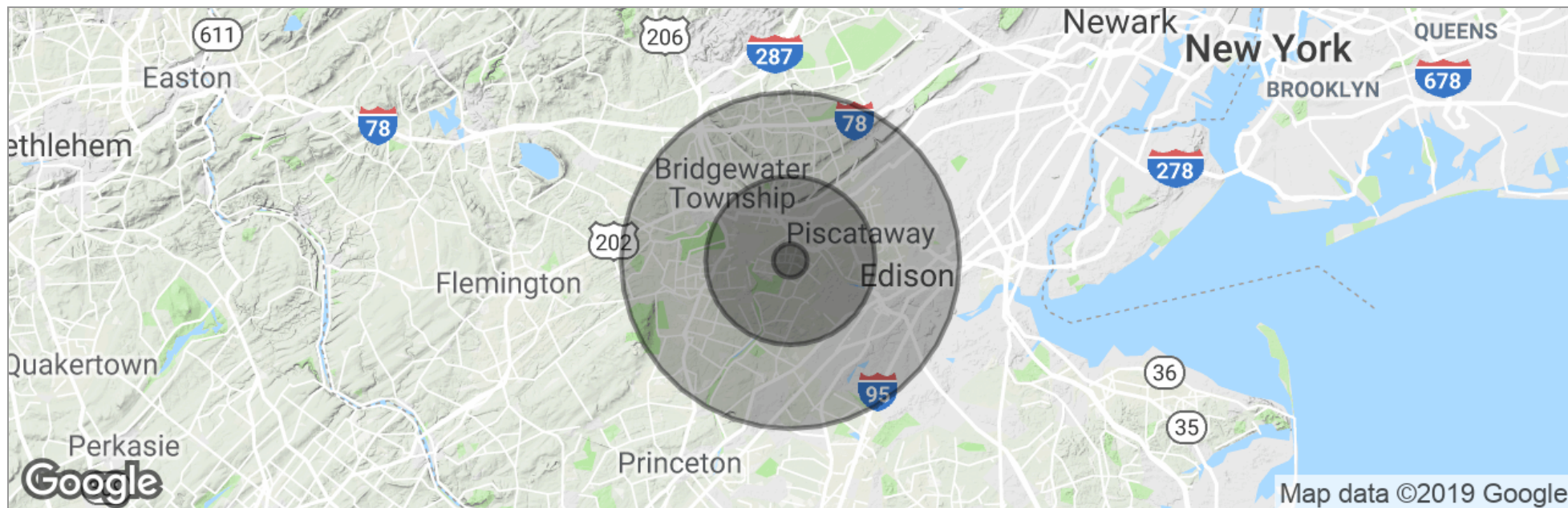

	1 Mile	5 Miles	10 Miles
Total Population	2,327	139,595	663,820
Population Density	741	1,777	2,113
Median Age	51.7	39.7	36.3
Median Age (Male)	50.5	38.0	35.1
Median Age (Female)	52.8	41.3	37.3
Total Households	1,014	50,950	223,942
# of Persons Per HH	2.3	2.7	3.0
Average HH Income	\$105,123	\$99,078	\$103,647
Average House Value	\$427,642	\$406,517	\$428,281

** Demographic data derived from 2010 US Census*

FOR MORE INFORMATION, PLEASE CONTACT:

William Sitar Jr. | P: 732.623.2155 | C: 973.202.9119 | bsitarlaw@sitarcompany.com
John Cranley | P: 732.623.2153 | C: 908.370.9808 | cranley@sitarcompany.com

1481 Oak Tree Road
Iselin, NJ 08830
T: 732.283.9000 | F: 732.283.3103
www.sitarcompany.com



Disclaimer: ALL INFORMATION FURNISHED REGARDING PROPERTY FOR SALE, RENTAL OR FINANCING IS FROM SOURCES DEEMED RELIABLE, BUT NO WARRANTY OR REPRESENTATION IS MADE AS TO THE ACCURACY THEREOF AND SAME IS SUBMITTED SUBJECT TO ERRORS, OMISSIONS, CHANGES OF PRICE, RENTAL OR OTHER CONDITIONS, PRIOR SALE, LEASE OR FINANCING OR WITHDRAWAL WITHOUT NOTICE.

FOR SUBLEASE | INDUSTRIAL

WAREHOUSE FOR SUBLEASE

245 Belmont Drive | Somerset, NJ 08873



Commercial Brokerage Leasing and Sales

Sitar Realty Company TCN Worldwide is a leader in the commercial brokerage industry of New Jersey. We are full-service brokerage firm and the largest remaining regional independently owned commercial brokerage firm in the state.

Property Management Services

Twin Brook Management, LLC is widely respected in the property management industry and can handle all aspects of property management. We offer full service management or a more limited management approach depending on the client's needs.

Property Tax Consulting

Our real estate tax team can provide an analysis of your property's taxes to determine if you are over- assessed and based on the results of our analysis we can reduce your property tax burden.

Insurance Services, Title Insurance

Sitar Insurance Agency, has competitive markets for all of your insurance needs. From personal lines, commercial lines, health, life and more. We understand your needs, and offer you insurance products to fit your needs and budget. Sitar Insurance Agency also is a licensed agent with Trident Abstract and can provide you with the best title services in the area. With Sitar, you can be confident your title is insured properly. Insure your title with a team who understands real estate like Sitar does.

Rent Receiver Services

Banks, law firms and courts rely on our company to preserve property values and stabilize properties that are in the process of foreclosure. Our hands-on approach, along with the latest technology allows our clients to feel comfortable and informed throughout the entire process.

Award-Winning Research

In today's real estate market, timely, accurate information can provide a competitive edge that our clients need to succeed. Our database allows us to access information pertaining to over 300 million square feet of office and industrial space and is updated continuously.

Consulting and Advisory Services

Our services range from multivariate financial analysis to interstate site selection. We can help to maximize your company's profits while your focus on your company's core business.

Development

Our development division has been responsible for the development of hundreds of millions of dollars of properties throughout New Jersey. Our firm is known for our high quality projects that are architecturally significant. Due to our years of experience, we can assist you at any level in the development process.

FOR MORE INFORMATION, PLEASE CONTACT:

William Sitar Jr. | P: 732.623.2155 | C: 973.202.9119 | bsitarlaw@sitarcompany.com
John Cranley | P: 732.623.2153 | C: 908.370.9808 | cranley@sitarcompany.com

1481 Oak Tree Road
Iselin, NJ 08830
T: 732.283.9000 | F: 732.283.3103
www.sitarcompany.com



Disclaimer: ALL INFORMATION FURNISHED REGARDING PROPERTY FOR SALE, RENTAL OR FINANCING IS FROM SOURCES DEEMED RELIABLE, BUT NO WARRANTY OR REPRESENTATION IS MADE AS TO THE ACCURACY THEREOF AND SAME IS SUBMITTED SUBJECT TO ERRORS, OMISSIONS, CHANGES OF PRICE, RENTAL OR OTHER CONDITIONS, PRIOR SALE, LEASE OR FINANCING OR WITHDRAWAL WITHOUT NOTICE.