

RETAIL PROPERTY // FOR LEASE

NEW CONSTRUCTION: EXCEPTIONAL MACK AVE STREET RETAIL

18155 MACK AVE
DETROIT , MI 48224



- Convenient New Retail Space for the Grosse Pointe Community
- 5,000-10,000 SF Available
- Coming Summer 2024
- Great Off-Street Parking as well on Mack Avenue
- 124,324 Population within a 3 Mile Radius



P.A. COMMERCIAL
Corporate & Investment Real Estate

26555 Evergreen Road, Suite 1500
Southfield, MI 48076
248.358.0100
pacommercial.com

We obtained the information above from sources we believe to be reliable. However, we have not verified its accuracy and make no guarantee, warranty or representation about it. It is submitted subject to the possibility of errors, omissions, change of price, rental or other conditions, prior sale, lease or financing, or withdrawal without notice. We include projections, opinions, assumptions or estimates for example only, and they may not represent current, past or future performance of the property. You and your tax and legal advisors should conduct your own investigation of the property and transaction.

18155 MACK AVE, DETROIT , MI 48224 // FOR LEASE

EXECUTIVE SUMMARY



Lease Rate

**\$27.50 SF/YR
(NNN)**

OFFERING SUMMARY

Building Size:	101,000 SF
Available SF:	5,000 - 10,000 SF
Year Built:	2024
Zoning:	Retail
Market:	Detroit
Submarket:	The Pointes

PROPERTY OVERVIEW

Great opportunity to lease 5,000-10,000 SF of retail space in the new EZ Storage building coming Summer 2024 on Mack Avenue. The property, which is located just north of the new Starbucks and south of McDonald's restaurant next to Ace Hardware, offers excellent exposure and parking in their off-street lot, as well as convenient street parking on Mack Avenue.

LOCATION OVERVIEW

Excellent location on Mack Ave just south of Moross Rd.

PROPERTY HIGHLIGHTS

- Convenient New Retail Space for the Grosse Pointe Community
- 5,000-10,000 SF Available
- Coming Summer 2024
- Great Off-Street Parking as well on Mack Avenue
- 124,324 Population within a 3 Mile Radius



P.A. COMMERCIAL
Corporate & Investment Real Estate

We obtained the information above from sources we believe to be reliable. However, we have not verified its accuracy and make no guarantee, warranty or representation about it. It is submitted subject to the possibility of errors, omissions, change of price, rental or other conditions, prior sale, lease or financing, or withdrawal without notice. We include projections, opinions, assumptions or estimates for example only, and they may not represent current, past or future performance of the property. You and your tax and legal advisors should conduct your own investigation of the property and transaction.

John E. De Wald, CPA PRINCIPAL

D: 248.663.0504 | **C:** 313.510.3777

johned@pacommercial.com

18155 MACK AVE, DETROIT , MI 48224 // FOR LEASE

PROPERTY DETAILS

Lease Rate	\$27.50 SF/YR
------------	---------------

LOCATION INFORMATION

Street Address	18155 Mack Ave
City, State, Zip	Detroit , MI 48224
County	Wayne
Market	Detroit
Sub-market	The Pointes
Cross-Streets	Mack Ave and Moran Rd
Side of the Street	Northwest
Signal Intersection	Yes
Road Type	Paved
Market Type	Medium
Nearest Highway	I-94
Nearest Airport	Detroit City Airport

BUILDING INFORMATION

Building Size	101,000 SF
Tenancy	Multiple
Number of Floors	5
Average Floor Size	20,200 SF
Year Built	2024
Gross Leasable Area	10,000 SF
Construction Status	Under construction
Condition	Excellent
Free Standing	Yes
Number of Buildings	1

PROPERTY INFORMATION

Property Type	Retail
Property Subtype	Street Retail
Zoning	Retail

PARKING & TRANSPORTATION

Parking Type	Surface
Number of Parking Spaces	50

UTILITIES & AMENITIES

Central HVAC	Yes
Leed Certified	No

18155 MACK AVE, DETROIT , MI 48224 // FOR LEASE

SITE PLANS

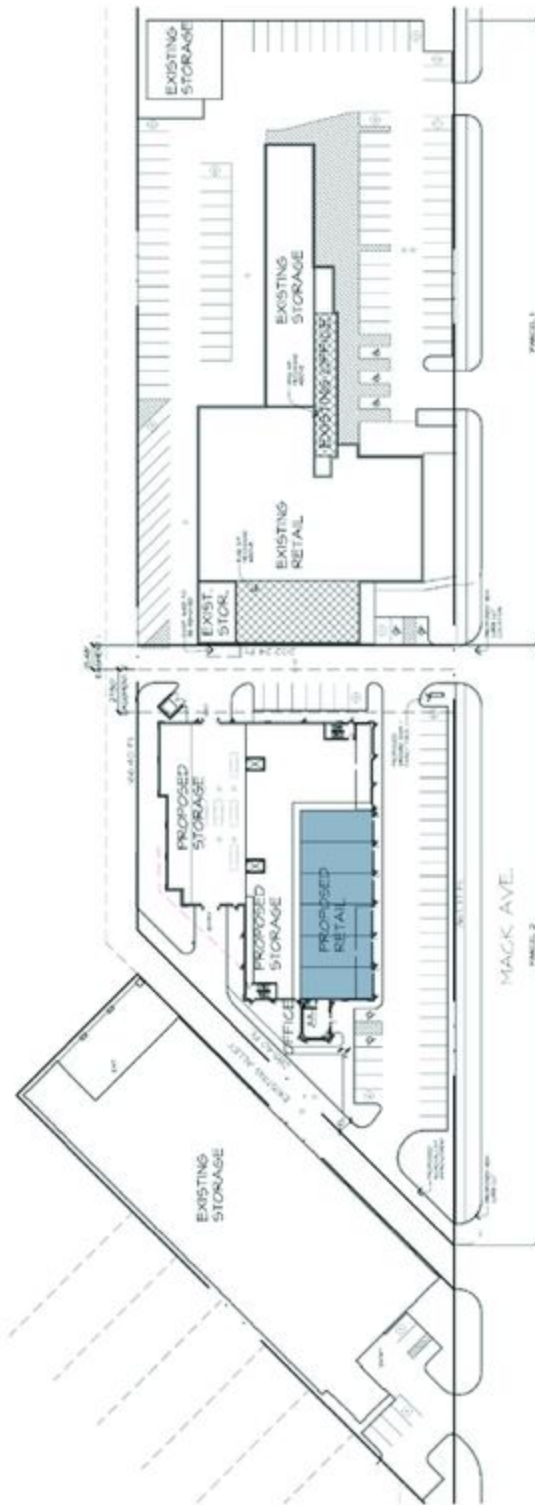

P.A. COMMERCIAL
Corporate & Investment Real Estate

John E. De Wald, CPA PRINCIPAL

D: 248.663.0504 | **C:** 313.510.3777

johned@pacommercial.com

We obtained the information above from sources we believe to be reliable. However, we have not verified its accuracy and make no guarantee, warranty or representation about it. It is submitted subject to the possibility of errors, omissions, change of price, rental or other conditions, prior sale, lease or financing, or withdrawal without notice. We include projections, opinions, assumptions or estimates for example only, and they may not represent current, past or future performance of the property. You and your tax and legal advisors should conduct your own investigation of the property and transaction.

18155 MACK AVE, DETROIT , MI 48224 // FOR LEASE

RETAILER MAP



P.A. COMMERCIAL
Corporate & Investment Real Estate

John E. De Wald, CPA PRINCIPAL

D: 248.663.0504 | C: 313.510.3777

johned@pacommercial.com

We obtained the information above from sources we believe to be reliable. However, we have not verified its accuracy and make no guarantee, warranty or representation about it. It is submitted subject to the possibility of errors, omissions, change of price, rental or other conditions, prior sale, lease or financing or withdrawal without notice. We include projections, opinions, assumptions or estimates for example only, and they may not represent current, past or future performance of the property. You and your tax and legal advisors should conduct your own investigation of the property and transaction.

18155 MACK AVE, DETROIT , MI 48224 // FOR LEASE

LOCATION MAP

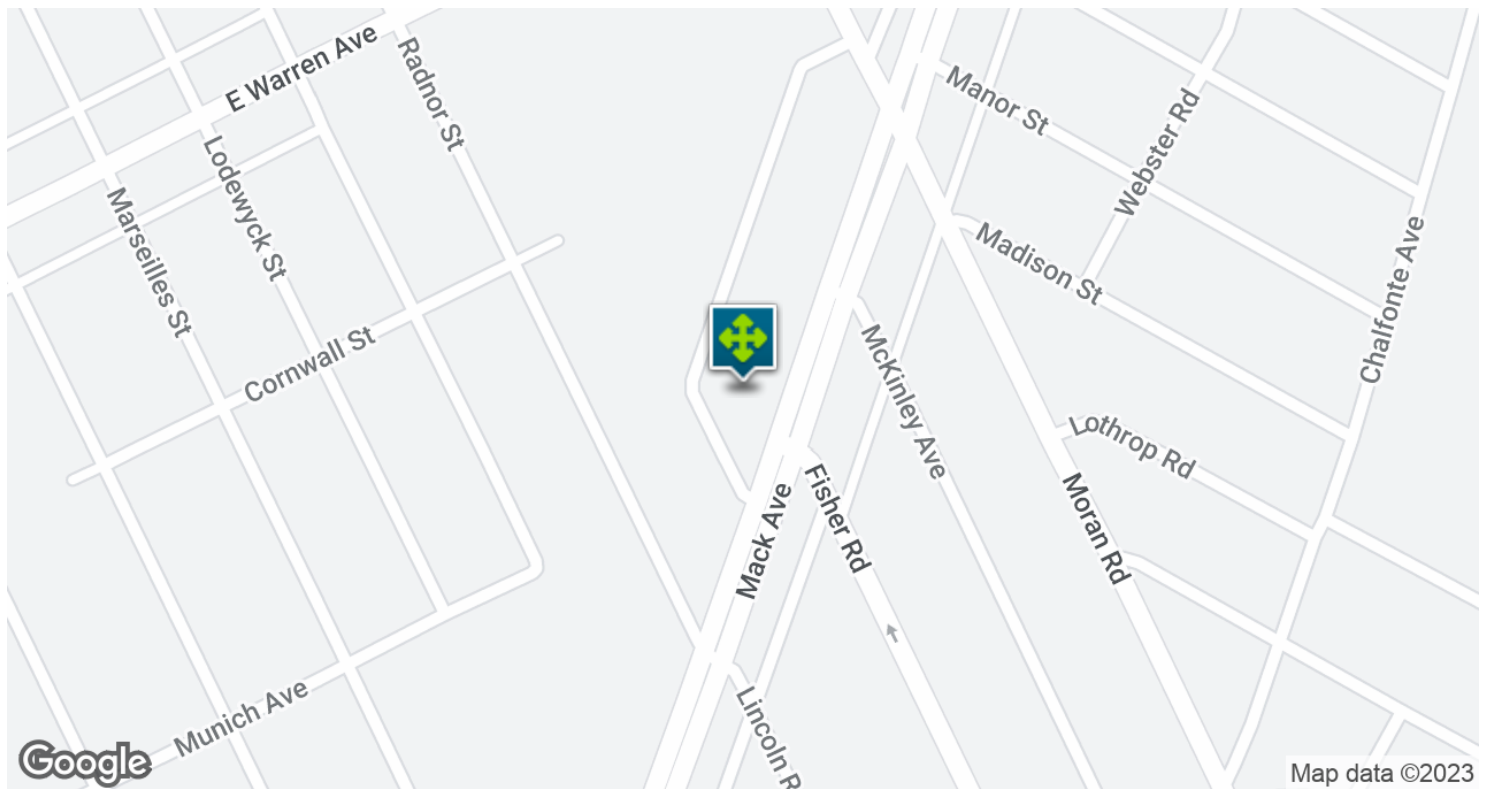
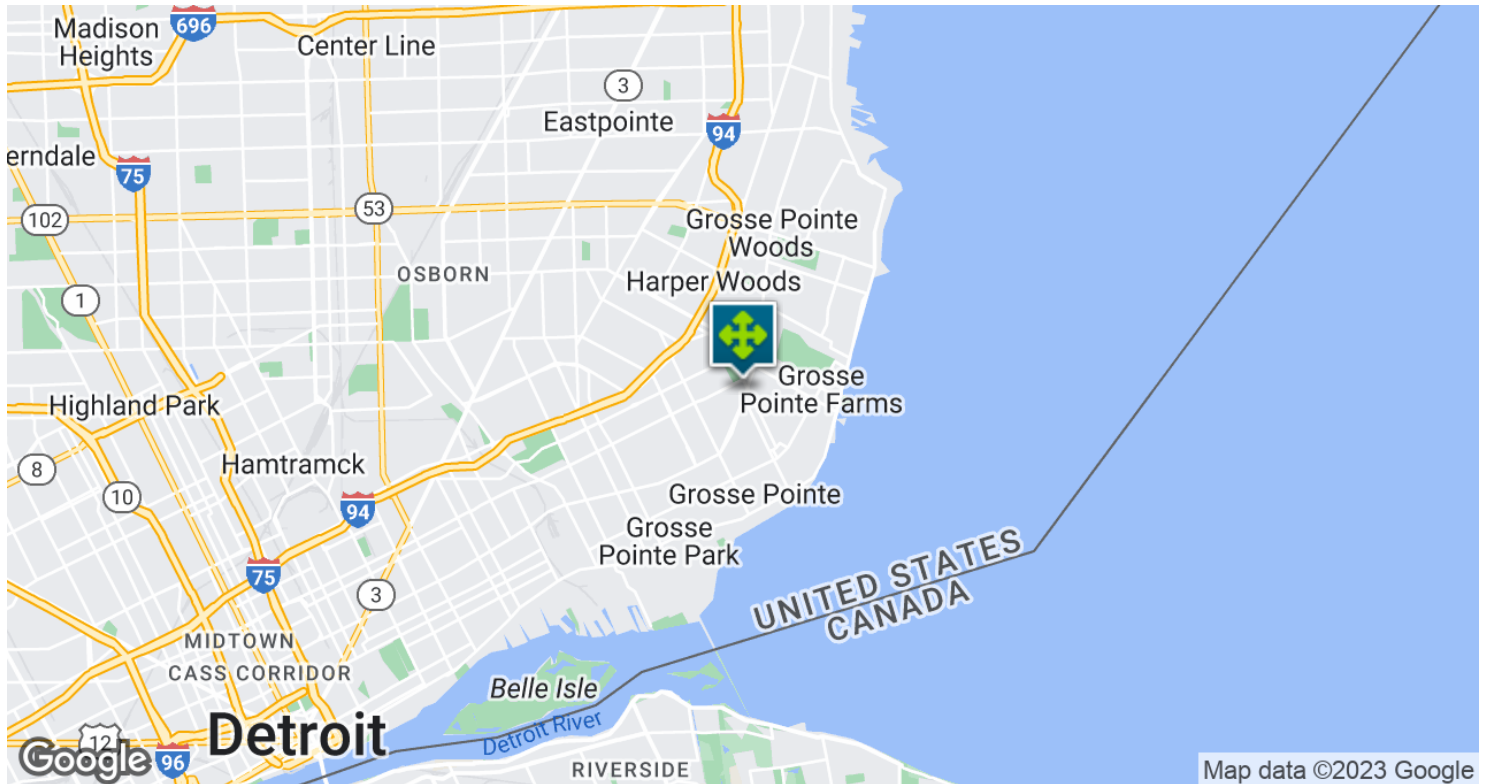

John E. De Wald, CPA PRINCIPAL
D: 248.663.0504 | C: 313.510.3777
johned@pacommercial.com

We obtained the information above from sources we believe to be reliable. However, we have not verified its accuracy and make no guarantee, warranty or representation about it. It is submitted subject to the possibility of errors, omissions, change of price, rental or other conditions, prior sale, lease or financing, or withdrawal without notice. We include projections, opinions, assumptions or estimates for example only, and they may not represent current, past or future performance of the property. You and your tax and legal advisors should conduct your own investigation of the property and transaction.

18155 MACK AVE, DETROIT , MI 48224 // FOR LEASE

DEMOGRAPHICS MAP & REPORT

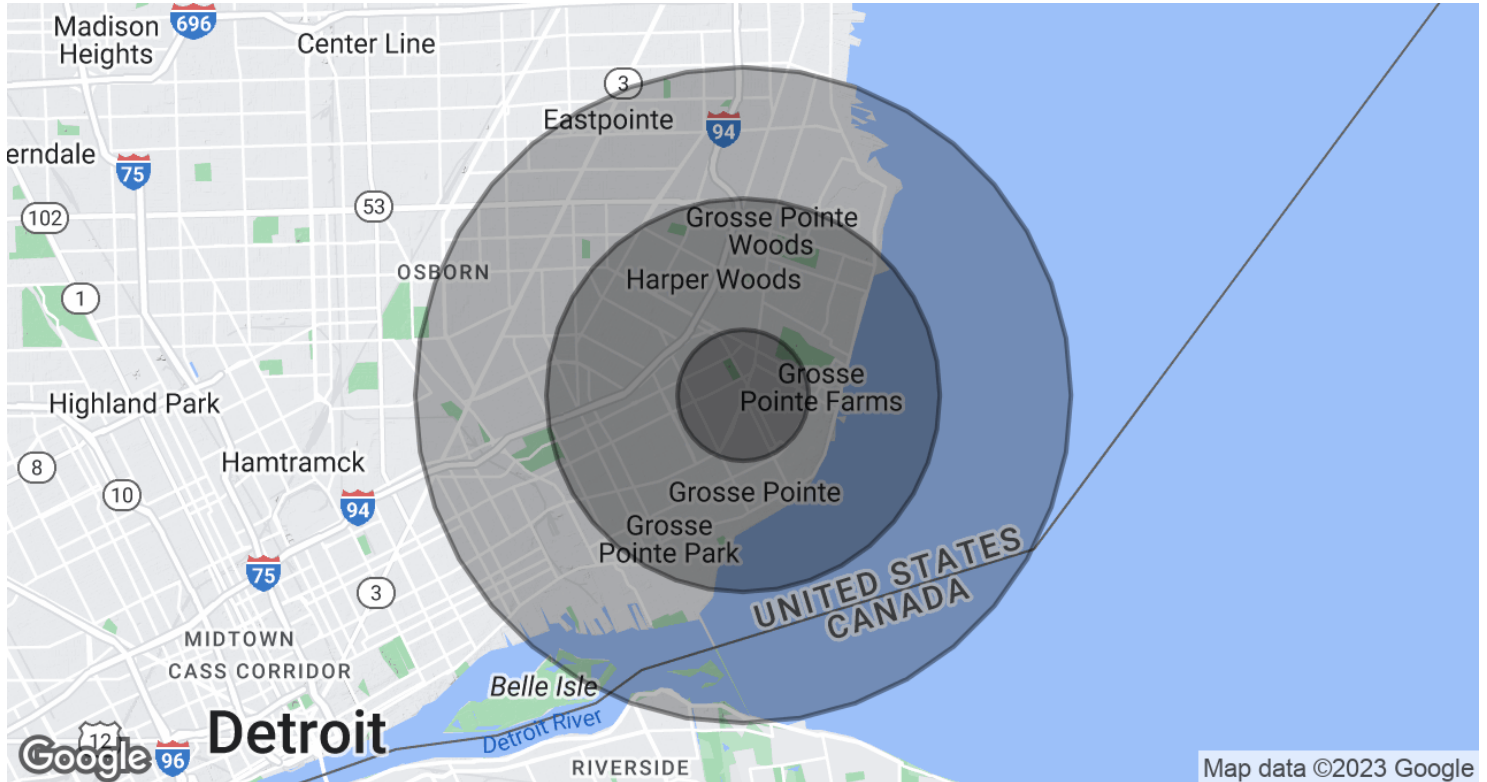

POPULATION	1 MILE	3 MILES	5 MILES
Total Population	16,666	124,324	268,359
Average Age	39.7	36.3	35.4
Average Age (Male)	39.2	33.7	33.2
Average Age (Female)	40.6	38.6	37.2

HOUSEHOLDS & INCOME	1 MILE	3 MILES	5 MILES
Total Households	5,781	44,159	97,267
# of Persons per HH	2.9	2.8	2.8
Average HH Income	\$85,897	\$77,085	\$62,569
Average House Value	\$228,636	\$232,714	\$184,221

* Demographic data derived from 2020 ACS - US Census

18155 MACK AVE, DETROIT , MI 48224 // FOR LEASE



FOR MORE INFORMATION, PLEASE CONTACT:



John E. De Wald, CPA
PRINCIPAL

D: 248.663.0504

C: 313.510.3777

johnd@pacommercial.com

P.A. Commercial

26555 Evergreen Road, Suite 1500
Southfield, MI 48076

P: 248.358.0100

F: 248.358.5300

pacommercial.com

Follow Us!



P.A. COMMERCIAL
Corporate & Investment Real Estate

We obtained the information above from sources we believe to be reliable. However, we have not verified its accuracy and make no guarantee, warranty or representation about it. It is submitted subject to the possibility of errors, omissions, change of price, rental or other conditions, prior sale, lease or financing, or withdrawal without notice. We include projections, opinions, assumptions or estimates for example only, and they may not represent current, past or future performance of the property. You and your tax and legal advisors should conduct your own investigation of the property and transaction.